

CHOKE SYSTEMS

A

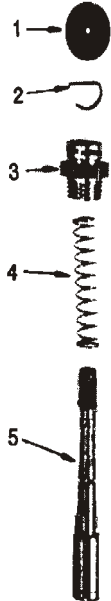

A. Pull-Up Type

DESCRIPTION	PART #	CARBURETOR
1. Rubber Cap, Starter	VM20/455	36-44 Spigot
2. Set Clip, Starter Plunger	VM14SC11/99	36-44 Spigot
3. Cap, Starter Plunger	VM20/300	36-44 Spigot
4. Spring, Starter Plunger	VM14SC11/89	36-44 Spigot
5. Starter plunger	VM38/06	36-44 Spigot

B

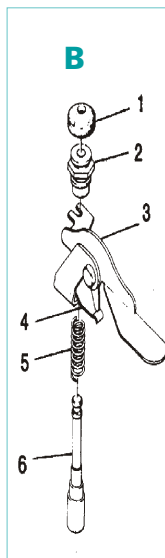

B. Lever Type

DESCRIPTION	PART #	CARBURETOR
1. Rubber Cap, Starter	VM20/455	All
2. Cap, Starter Plunger	VM20/456	All
3. Lever, Starter	VM28/135.so	26
	VM28/497.so	28
	VM28/154.so	30 - 34
	VM32/53	36 - 38
	VM36/58.so	40 - 44
4. Spring Plate, Starter Level	VM26/09C	26 - 28
	VM32/17	30 - 44
5. Spring, Starter plunger	VM16/42	All
6. Starter Plunger	VM15/62	24 - 28
	VM18/144	30 - 44

C

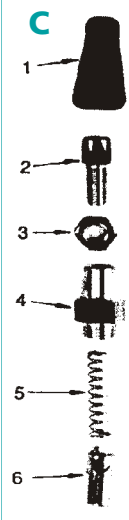

C. Cable Type

- Complete Kit Available on page 24 - (part # 724-4751)
- Snowmobile carburetors come with cable operated starter systems

DESCRIPTION	PART #	CARBURETOR
1. Rubber Cap, Starter	VM26/46	30 - 44
2. Cable Adjuster	M18F/43A	30 - 44
3. Adjusting Lock Nut	B30/247	30 - 44
4. Cap, Starter Plunger	VM15/37	30 - 44
5. Spring, Starter Plunger	VM14SC11/89	30 - 44
6. Starter Plunger	VM15SC4/85	30 - 44