

OPTIMA CLUTCH AND LEVER SET



Lever set (w/ dust boot, nylon mounting bushing, and cable adjuster)



Optima O.T.P Right Hand Hot Shot

OPTIMA CLUTCH LEVER SET

- Injection molded dust cover and barrel end
- New on-the-fly cable adjuster with spring loaded detent
- Nylon mounting bushing
- New lightweight CNC machined bar clamp
- Top loading hardware
- Extra thick lever pivot
- Hot start button features the same aggressive knurling found on the Optima clutch cable adjuster.



DESCRIPTION/COLOR	TCI #	
Replacement Lever	720-0002	\$28.95-H
Replacement Dust Boot	720-0005	\$5.95-H
Optima O.T.P Right Hand Hot Start Black	720-0003	\$79.95-H



Cable Adjuster

CLUTCH LEVER ASSEMBLIES



ROLLER BEARING QUICK ADJUST CLUTCH ASSEMBLY

720-8020

\$99.95-H

- Quick adjust with CNC machined billet clutch perch
- All features of Quick Adjust plus a roller bearing in the lever
- Forged aluminum for lasting durability

Replacement Lever with bearing

720-8021

\$19.95-H

Replacement Cable Adjuster

720-8031

\$9.95-H

Rubber cover

720-8032

\$3.95-H



TRI-STAR ROLLER BEARING QUICK ADJUST CLUTCH

720-8030

\$109.95-H

- Billet aluminum perch
- New Tri-star shape makes adjusting your clutch during a race even easier
- Spring loaded ball bearings fall into detents for a positive feel
- Sealed roller bearing and tension adjustment in lever makes clutch feel smoother
- Nylon perch bushing

Replacement Lever for Quick Adjust

720-8021

\$19.95-H

Replacement Cable Adjuster

720-8031

\$9.95-H

Replacement Cable Adjuster with Boot

720-8034

\$39.95-H

Replacement Screw, Spring & Ball Kit

720-8033

\$5.95-H



EZ PULL CLUTCH REPLACEMENT LEVER FOR 56-6465

720-8011

\$9.95-H

- Honda style lever
- Forged aluminum for lasting durability



QUICK ADJUST CLUTCH REPLACEMENT PARTS FOR 56-6460

- Honda style lever

Replacement Lever for Quick Adjust

720-8001

\$12.95-H

Rubber Cover

720-8032

\$3.95-H

Replacement Cable Adjuster

720-8031

\$9.95-H

FOREVER LEVER ASSEMBLY

FOREVER LEVER ASSEMBLY

- Deflects upon impact in any direction except towards the handle bars.
- Spring loaded assembly with adjustable tension to allow rider to customize to their riding style.
- Folds away in the event of an accident reducing the chance of being injured by a broken lever.
- Made from the highest quality die cast aluminum.
- Completely serviceable and rebuildable with Aluminum components warranted forever.

Polished Universal Cable Clutch w/Perch	721-0001	\$99.95-H
Black Universal Cable Clutch w/perch	721-0008	\$89.95-H
Black Hydraulic Brake Lever	721-0009	\$77.95-H
Polished Hydraulic Brake Lever	721-0007	\$99.95-H
KTM Hydraulic Polished Brake Lever	721-0022	\$99.95-H

FOREVER LEVER ONLY

Honda CR / XR Clutch Lever	721-0003	\$64.95-H
KTM Polished Clutch Lever	721-0010	\$99.95-H
Hot Start Lever Polished	721-0020	\$51.95-H

REPLACEMENT ITEMS

Offset Perch - Quick Adjust w / Reach Adjuster	721-0004	\$34.95-H
Rebuild Kit	721-0005	\$34.95-H
Race Boot - 2 Packaged	721-0006	\$8.95-H

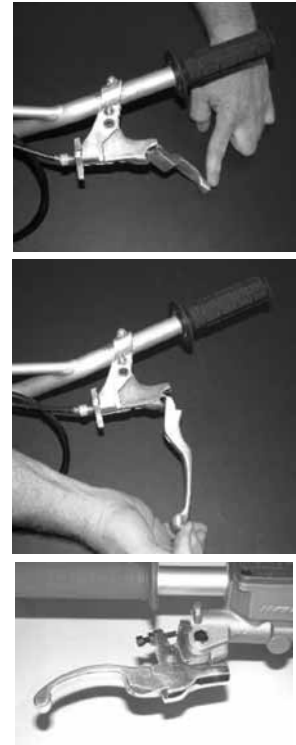

FIRE POWER HYDRAULIC LEVERS

MODEL	DESCRIPTION	PART#	RETAIL
Honda			
XR250 '83-'85	Black	E30-30052	\$5.95-J
XR250 '86-'95	Black	E30-30053	\$8.95-J
XR 600 '85-'00	Black	E30-30053	\$8.95-J
Kawasaki			
KX125, 250,500 '88-'89	Black	E30-30055	\$10.95-J
KDX 200, 250 '88-'94	Black	E30-30055	\$10.95-J
KX 125 '90-'92	Black	E30-30056	\$13.95-J
KX 250'90-'92	Black	E30-30056	\$13.95-J
KX 500'90-'93	Black	E30-30056	\$13.95-J
Suzuki			
RM 125,250, 500/ '89-'95	Blue	E30-30057	\$10.95-J
DR250, 350			
Yamaha			
YZ 125,250, 490/'86-'88	Black	E30-30058	\$13.95-J
IT200, 250/TT350			
YZ 125,250, 250WR'89-'93	Black	E30-30060	\$13.95-J

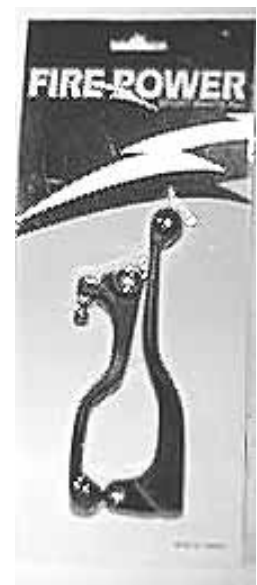

LEVERS & BRACKETS



MODEL	DESCRIPTION	PART#	RETAIL
Honda			
Bracket & Lever Control Assembly	Black/Black	E32-73600	\$21.95-J
Honda XR			
Alloy	E30-73660	\$9.95-J	
Black	E30-73662	\$11.95-J	



GP SHORT LEVER CONTROL ASSEMBLIES

- Black competition lever control sets

DESCRIPTION	PART #	RETAIL
Honda Lever Assembly (pair)	E32-73600	\$21.95-J
Lever Long Chrome/Aluminum Pair	720-455	\$5.95-J

LEVERS



MODEL	DESCRIPTION	PART#	RETAIL
Suzuki			
GN400T '82	Clutch	E30-79452	\$4.95-J
GN805G '83	Clutch	E30-79452	\$4.95-J

Harley Davidson

Big Twin & XL Models '82-93	Brake & Clutch	E07-89030	\$27.95-J
-----------------------------	----------------	-----------	-----------

GP SHORT LEVER SETS

- Competition short style lever sets
- Available in two finishes - black or polished



DESCRIPTION	PART #	RETAIL
Honda XR Polished	E30-73660	\$9.95-J
Honda XR Black	E30-73662	\$11.95-J
Suz OEM 57300/57420-49100 Black	E30-64801	\$4.95-J



KAWASAKI LEVER BLADES

720-501

\$11.95-J

- Replacement blades constructed of lightweight composite Plastic material
- Will fit all Japanese non-hydraulic motorcycles
- Black
- Sold in pairs

EMGO DIRT LEVERS

Model	Year(s)	Clutch	Brake
Honda			
XR80R	85-95	E30-24002	
XR100R	85-95	E30-24002	
XR 200	80-84	E30-24002	
XR 200R	81-95	E30-24002	
XR 250/R	80-82	E30-24002	
XR 250R	83-85	E30-24002	
XR 250R	86-95	E30-24002	
XR 350R	1983/85	E30-24002	
XR 350R	1984	E30-24002	
XR 350R	1985	E30-24002	
XR 500R	80-84	E30-24002	
XL 600L	89-90	E30-24002	
XR 600R	85-00	E30-24002	
Kawasaki			
KX 80E1	83	E30-32912	E30-32911
KX80	84-95	E30-32912	
	96-97	E30-32912	E30-32991
	97-00		E30-32991
KX 100	94-95	E30-32912	
	96-97	E30-32912	E30-32991
	98-99		E30-32991
KLX 125	84-04	E30-32912/F	
KX 125	82-89	E30-32912	
	97-99		E30-32991
KDX 175	80-81	E30-32912	E30-32911
KDX 200	83-85	E30-32912	E30-32911
	86-07	E30-32912	
KDX 220	84-04	E30-32912/F	
KDX 250	82-84	E30-32912	E30-32911
	91-94	E30-32912	
KL 250	83-84	E30-32912	E30-32911
KLX 250	94-96	E30-32912	
KX 250	82-89	E30-32912	
	97-99		E30-32991
KXT 250	82-83,85	E30-32912	
KLX 300	96-04	E30-32912/F	
KLX 400	03-04	E30-32912/F	
KDX 450	82	E30-32912	E30-32911
KX 500	83-89	E30-32912	
	97-03		E30-32991
KLX 650	96	E30-32912	

Model	Year(s)	Clutch	Brake
Suzuki			
RM 80	86-88	E30-79452	
DR 100	83-89	E30-79452	
DR 125	82-88	E30-79452	
RM 125	85-88	E30-79452	
RM 250	85-88	E30-79452	
DR650 S/SE	90-93	E30-79452	
Yamaha			
YZ 50	80		E30-51161
BW 80	86-88		E30-51161
PW 80 Zinger	95-06		E30-51161
YZ 80	79-85		E30-51161
TTR90	06-09		E30-51161
MX 100	81-83		E30-51161
RT 100	89-97		E30-51161
YZ 100	75-83		E30-51161
IT 125	80-81		E30-51161
YZ 125	78-82		E30-51161
	83-84		E30-51161
DT 175	78-81	E30-51222	
IT 175	79-83		E30-51161
MX 175	81		E30-51161
RT 180	90-93		E30-51161
BW 200	86-88		E30-51161
TW 200	00-04		E30-51161
TW 200 Trailway	87-95		E30-51161
XT 225	97-05		E30-51161
DT 250	79-81	E30-51222	
IT 250	79-83		E30-51161
TT 250	80-82		E30-51161
YZ 250	78-84		E30-51161
BW 350	87-88		E30-51161
TY350 Trails	85-86		E30-51161
IT 465	81-82		E30-51161
YZ 465	80-81		E30-51161
IT 490	83-84		E30-51161
YZ 490	82-84		E30-51161
XT 500	79-81	E30-51222	
TT 600	83-84		E30-51161



On Line Ordering available at www.transcanimports.com

Place an order, view stock, check out suggested retail pricing.

View the latest versions of our catalogues at www.transcanimports.com

And click on the icon of the catalogue you wish to view



EMGO ATV LEVERS

Model	Year(s)	Clutch	Brake
Honda			
TRX90	93-01	E30-27081	
ATC110	83	E30-27001	
	84	E30-27091	
	85	E30-27081	
ATC125M	84	E30-27091	E30-27002
	85-86	E30-27081	E30-27012
	87		E30-27002
TRX125	85		E30-27012
TRX125 Four Trax	85-88		E30-27002
ATC185/S	80-82		E30-26411
	83	E30-27001	E30-27002
ATC200/E	81-82		E30-26411
	83	E30-27001	E30-27002
ATC200ES Big Red	84	E30-27091	E30-27002
ATC200M/S	84	E30-27091	E30-27002
	85-86	E30-27081	E30-27012
ATC200X	83-87	E30-27021	E30-27031
TRX200/D	84,90-97		E30-27032
TRX200SX	86-88	E30-27021	E30-27032
ATC250ES Big Red	85		E30-27012
ATC250R	81-86	E30-24002	E30-27031
ATC250SX	85-87	E30-27051	E30-27022
TRX250	85-86	E30-27051	E30-27032
TRX250 Four Trax	85-87	E30-27051	E30-27032
TRX250R	86-89		E30-27021
TRX250 Recon	97-01	E30-27051	
TRX250EX	01-05	E30-27051	E30-27032
TRX250TE/TM	02-05	E30-27051	
TRX300/FW	96-00	E30-27051	
TRX300	99-00	E30-27051	E30-27032
TRX300EX	93-05		E30-27032
TRX350FE/FM	04-05	E30-27051	E30-27032
TRX350TE/TM	04-05	E30-27051	E30-27032
ATC350X	84-87	E30-27021	E30-27031
TRX350/D	86-88	E30-27051	
TRX400EX	99-05		E30-27032
TRX400FW	95-03	E30-27051	E30-27032
TRX450ES	98-00	E30-27051	E30-27032
TRX450FE/FM	98-04	E30-27051	E30-27032
TRX450S	98-00	E30-27051	E30-27032
Kawasaki			
KLT200C	84	E30-32912	E30-32911
KLT250 C2-C3	84-85	E30-32912	
KX250	97-98		E30-32991
KXT250A Tecate	84	E30-32912	E30-32911
KXT250 A2/B1	85-86	E30-32912	
KXT250 B2 Tecate	87-88	E30-32912	

Model	Year(s)	Clutch	Brake
Suzuki			
LT230GE	86-89	E30-64812	E30-64811
LT230E	87-90	E30-64812	E30-64811
	91-93	E30-64812	
LT230S	85-89	E30-64812	E30-64811
LT-F230	86-87		E30-64811
LT-F230E Quadrunner	1985		E30-64801
LT250EF	85-86		E30-64801
LT250R	85-91	E30-64812	E30-64811
LT250S	89-90	E30-64812	E30-64811
LT-F250	88-90	E30-79452	E30-64811
	91-92	E30-79452	
LT300E	87-89		E30-64811
LT4WD	87-91	E30-79452	
LT4WDH	87-93	E30-79452	E30-64801
LT500R	87-90	E30-64812	E30-64801
Yamaha			
YFM80 Moto-4	87-88		E30-51181
YFM100 Champ	87-89		E30-51181
YFM125GHX Grizzly 125	05-09		E30-51181
YFM200 Moto-4	83-85		E30-51161
YFM200DX	86-91		E30-51181
YFS200 Blaster	88-93	E30-51152	
YFAIK Breeze	99-03		E30-51181
YTM200 Tri-Moto	83-85		E30-51161
YFM225 Moto-4	86-88		E30-51181
YTM225 Tri-Moto	83-85		E30-51161
YFB250 Timberwolf	94-00		E30-51181
YFM250X	99-04		E30-51181
YTZ250 Tri-Moto	85-86		E30-51181
YFM350FR Moto-4	87-88		E30-51181
YFM350FW Big Bear	87-99		E30-51121
YFM350FX Wolverine	95-98	E30-51152	
YFM350X Warrior	98-05	E30-51152	
YFP350 Terrapro	88		E30-51181
YFZ350 Banshee	87-03	E30-51152	
YFM350 Timberwolf	96		E30-51121
YFM400FW Kodiak	94-98		E30-51121
YFM600 Grizzly	98-01		E30-51121

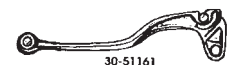
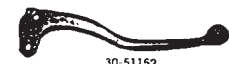
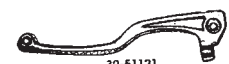
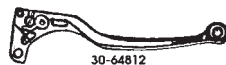
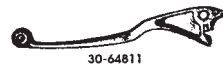
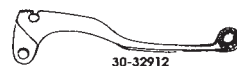
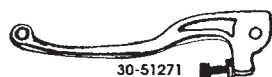

LEVER PERCHS



SPLIT PERCH LEVER BRACKETS

- Replacement lever brackets for Honda ATV's.
- Complete with cable adjusters, nuts, screws and bolts.

KEY:

P = No parking brake notch
N = Single brake pin notch
DN = Double brake pin notch
DC = Dual cable type bracket

EMGO #	SIDE	TYPE	KEY	OEM REF.	APPLIC.	YEAR
E34-37211	Right	Alloy	P	53171-958-000	ATC185/S/200	80-83
				53171-958-010	ATC200E/ES/M	82-84
E34-37212	Left	Alloy	DN	53172-918-000	ATC90/110/185	70-83
	Left			53172-958-000	ATC185S/200/E	81-83
E34-37222	Left	Alloy	N	53172-968-000	ATC110, 125M, ATC200M	
E34-37231	Right	Black	P	52171-HA0-680	ATC125M/250ES	85-87
E34-37241	Right	Alloy	P	53171-VM4-680	TRX125	85-88
				53171-VM6-000	ATC200M/S	85-86
				53171-VM6-680	ATC250ES	85-87
E34-37232	Left	Black	DN	53172-969-680	ATC110, 125M	85
E34-37242	Left	Alloy	DN		ATC200M/S	85
E34-40902	Left	Black	DC	53172-HA0-680	ATC125M	85-87
E34-40912	Left	Alloy	DC	53172-HA0-681	TRX125	85-88
				53172-HA6-000	TRX200SX	86-88
				53171-HA6-680	ATC250ES/SX	85-87
				53171-HA8-680	TRX250	85-87
				53171-HA8-681	TRX300/FW	88
				53171-VM6-000	TRX350/D	87-88
E34-40922	Left	Black	DC	53172-961-000	ATC200X	83-87
	Left				ATC250R	81-86
					TRX250R	86-88
					ATC350X	85-86

LEVER PIN BOLTS

\$.50-J

- Comes complete with nut

FITMENT

Honda
 Yamaha, Suzuki & Kawasaki

PART #

E34-73507
 E34-73508



TWO PIECE STYLE LEVER BRACKETS

- Split Two Piece Lever Brackets
- Complete with cable adjusters, nuts, screws & bolts

PART #	FITMENT	OEM	RETAIL
Honda			
E34-37201	Blk. Brake	53171-376-000	\$5.95-J
Kawasaki			
E34-38102	Blk. Clutch KX '90 & up	13091-1680	\$5.95-J
Yamaha			
E34-73801	Blk. Brake	n/a	\$5.95-J
E34-73802	Blk. Clutch	n/a	\$6.50-J



TMV GEAR SHIFT LEVERS

\$37.95

- Forged aluminum that's tougher and less expensive than stock.
- Perfect OEM fit.
- Hinged shift tip folds back on impact.
- Satin anodized finish resists corrosion.

APPLICATION	YEAR	PART	COLOR	APPLICATION	YEAR	PART	COLOR
GasGas				KTM			
	'98-	600-1050	Silver	SX65	'98-08	600-1042	Orange
Honda				SX65	'98-08	600-1043	Silver
CR85	'96-07	600-1002	Red	SX65	'09-	600-1048	Orange
CR85	'96-07	600-1003	Silver	SX65	'09-	600-1049	Silver
CR125	'85-07	600-1004	Red	SX85	'03-	600-1044	Orange
CR125	'85-07	600-1005	Silver	SX85	'03-	600-1045	Silver
CRF150	'07-	600-1000	Red	KTM 2 Stroke		600-1036	Orange
CRF150	'07-	600-1001	Silver	KTM 2 Stroke		600-1037	Silver
CR250	'84-01	600-1006	Red	KTM 4 Stroke		600-1040	Orange
CR250	'02-07	600-1009	Red	KTM 4 Stroke		600-1041	Silver
CR250	'02-07	600-1010	Silver	Suzuki			
CR250F	'04-09	600-1013	Red	RM85	'89-	600-1022	Silver
CR250F	'04-09	600-1014	Silver	RM125	'89-	600-1021	Gold
CR250F	'10-	600-1038	Red	RMZ250	'04-06	600-1019	Silver
CR250F	'10-	600-1039	Silver	RMZ250	'07	600-1018	Silver
CR450F	'02-04	600-1013	Red	RMZ250	'08-	600-1033	Blue
CR450F	'02-04	600-1014	Silver	RMZ250	'08	600-1034	Silver
CR450F	'05-08	600-1007	Red	RMZ450	'05-07	600-1020	Silver
CR450F	'05-08	600-1008	Silver	RMZ450	'08-	600-1029	Blue
CR450F	'09-	600-1011	Red	RMZ450	'08-	600-1030	Silver
CR450F	'09-	600-1012	Silver	Yamaha			
Kawasaki				YZ80/85	'83-	600-1035	Silver
KX125	'94-	600-1015	Silver	YZ125/250	'96-04	600-1023	Blue
KX250	'94-	600-1015	Silver	YZ125/250	'96-04	600-1024	Silver
KX250F	'04-05	600-1019	Silver	YZ125/250	'05-	600-1025	Blue
KX250F	'06-08	600-1017	Silver	YZ125/250	'05-	600-1026	Silver
KX250F	'09-	600-1047	Silver	WR250	'01-	600-1031	Blue
KX450F	'06-08	600-1016	Silver	WR250	'01-	600-1032	Silver
KX450F	'09-	600-1046	Silver	YZ250F	'01-	600-1031	Blue
				YZ250F	'01-	600-1032	Silver
				YZ450F	'03-	600-1027	Blue
				YZ450F	'03-	600-1028	Silver



FOLDING GEAR SHIFT LEVERS

- Replacement shift levers that fold to help prevent bending & breakage of the shifter shaft and lever
- Blister packed

1 - Folding Shift Lever 2 - Heel/Toe Shift Lever 3 - Folding Lever 4. Forged Shift Lever

DESCRIPTION	YEAR	PART #	TYPE	RETAIL
Honda				
CR 125	'90-'97	E83-88086	3	\$14.95-J
CR 125	'87-88	E83-88040	3	\$14.95-J
TRX250	'86-89	E83-88043	1	\$13.95-J
TRX 300	'88-91/'96-00	E83-88042	1	\$16.95-J
TRX 300/FW	'92-00	E83-88048	2	\$16.95-J
TRX 350 EX		E83-88043	1	\$13.95-J
TRX 400	'95-98	E83-88044	1	\$14.95-J
TRX 400EX	'99-07	E83-88046	1	\$14.95-J
TRX 400	'99-01	E83-88047	2	\$14.95-J
TRX 400 FM	'95-02	E83-88047	2	\$14.95-J
TRX 400 FW	'95-'03	E83-88047	2	\$14.95-J
TRX 450 FE/FM	98-05	E83-88047	2	\$14.95-J



KAWASAKI				
KX 60	'83-03	E83-88050	1	\$14.95-J
KX 80	'83-90	E83-88050	1	\$14.95-J
KX 125	'83-93	E83-88050	1	\$14.95-J
KX 125	'94-02	E83-88052	1	\$14.95-J
KX125/KX250	'83-93	E83-88051		\$14.95-J
KLF 220 Bayou	'89-02	E83-88053	1	\$16.95-J
KLF 250 Bayou	'03-07	E83-88053		\$16.95-J
KX 250	'84-93	E83-88050	1	\$14.95-J
KX 250	'94-02	E83-88052	1	\$14.95-J
KX 500	'87-93	E83-88050	1	\$14.95-J
KX 500	'94-04	E83-88052	1	\$14.95-J

SUZUKI				
RM 100	'76-81	E83-88083	1	\$14.95-J
RM 125	'75-80	E83-88083	1	\$14.95-J
PE 250	'80-81	E83-88085	1	\$14.95-J
RM 250	'80-85	E83-88085	1	\$14.95-J
RM 370	'76-77	E83-88083	1	\$14.95-J
RM 400	'78-80	E83-88083	1	\$14.95-J
RM 465	'81-83	E83-88085	1	\$14.95-J
RM 500	83-84	E83-88085	1	\$14.95-J
GXSR 600	'92-93	E83-88012	4	\$49.95-J

YAMAHA				
IT/MX/YZ		E83-88082	1	\$14.95-J
YFM 250	'99	E83-88077	1	\$14.95-J
YFM 350 Big Bear 2WD	'93-98	E83-88079	2	\$16.95-J
YFM 350 Big Bear 4WD	'93-99	E83-88078	2	\$19.95-J
YFM 400 Kodiak 2WD	'93-98	E83-88079	2	\$16.95-J
YFM 400 Kodiak 4WD	'93-99	E83-88078	2	\$19.95-J

NON-FOLDING GEAR SHIFT LEVERS

EMGO UNIVERSAL NON-FOLDING SHIFT LEVER

E83-88010

\$8.95-J

Fits: Honda CB 750 up to 1978/CB 500/XL 80/XL 100/XL 200/XL 250/XL 500R / XL 500S
 Kawasaki K 100
 Suzuki GS 750 E/GS 750 L/GS 850/GS 1000/GS 1100G / GS1100GK
 Yamaha 650 Maxim/XS 1100



Model	Year(s)	Part#
Honda		
XL250R	81-83	E83-61611
XL250R	84-87	E83-61612
XL250S	78-81	E83-61611
XR250	79-80	E83-61611
XR250R	84-91	E83-61612
XL350R	84-85	E83-61612
XR350R	83-84	E83-61612
XL500R	82	E83-61612
XL500S	79-81	E83-61612
XR500R	83-84	E83-61612
XL600R	82-86	E83-61612

Model	Year(s)	Part#
Kawasaki		
KE124	80-83	E83-61640
KDX175	80-82	E83-61640
KE175	80-83	E83-61640
KDX250	80-83	E83-61640
KL250	78-83	E83-61640
KLX250	79-80	E83-61640
KX250	80-86	E83-61640

DAYTONA RACING PRODUCTS

SHINDY STEERING DAMPER KIT

- Kits include an individual length of stabilizer and complete bolt-on brackets without rivet mounting for easy and secure installation.

Application	Year	Mounting Place	TCl#	Retail
Honda				
NT650 Hawk GT	88-90	Left Hand Side	712-2104	\$299.95-H
CBR600F3	95-98	Inside of Fairing	712-2107	\$299.95-H
CBR600F2	91-94	Inside of Fairing	712-2107	\$299.95-H
CBR900RR	93-97	Inside of Fairing	712-2108	\$269.95-H
CBR900RR	98-99	Inside of Fairing	712-2112	\$299.95-H
CBR600F4	99-00	Left Hand Side	712-2115	\$399.95-H
CBR600F4i	01-04	In Front of Gas Tank	712-2115	\$399.95-H
Kawasaki				
ZX750M ZX-7R	93-94	Right Hand Side	712-2206	\$379.95-H
ZX750L ZX-7	93-95	Right Hand Side	712-2206	\$379.95-H
ZX-6R	95-97		712-2207	\$299.95-H
ZX600G ZX-6R	98-99	Inside of Fairing	712-2208	\$359.95-H
ZX900C ZX-9R	98-99	Inside of Fairing	712-2208	\$359.95-H
Suzuki				
GSXR750	85-87		712-2301	\$239.95-H
GSXR750	00-02	Inside of Fairing	712-2309	\$359.95-H
GSXR1000	02	Inside of Fairing	712-2309	\$359.95-H
Yamaha				
VMX12 V-Max	85-92	Left Hand Side	712-2406	\$299.95-H
VMX12 V-Max	93-05	Left Hand Side	712-2408	\$299.95-H
YZF-R6	99-02	Inside of Fairing	712-2410	\$399.95-H



SHINDY ONE PIECE LIGHTWEIGHT FORK BRACKETS

\$55.95-H

- For mounting steering stabilizer to the fork tube.
- Lightweight one-piece brackets machined from billet aluminum.

FORK SIZE	PART #
36 mm	712-2502
41 mm	712-2506
42 mm	712-2507

SHINDY BUELL STABILIZER MOUNTING BRACKETS

712-3251

\$199.95-H

- Buell S1 / 2 / 2T / 3 / 3T '95-98

DAYTONA STABILIZER PARTS

712-3002

\$31.95-H

- Individual replacement parts for both oval and round type steering stabilizers