

LEVER PERCHS



SPLIT PERCH LEVER BRACKETS

- Replacement lever brackets for Honda ATV's.
- Complete with cable adjusters, nuts, screws and bolts.

KEY:

P = No parking brake notch
N = Single brake pin notch
DN = Double brake pin notch
DC = Dual cable type bracket

EMGO #	SIDE	TYPE	KEY	OEM REF.	APPLIC.	YEAR
E34-37211	Right	Alloy	P	53171-958-000	ATC185/S/200	80-83
				53171-958-010	ATC200E/ES/M	82-84
E34-37212	Left	Alloy	DN	53172-918-000	ATC90/110/185	70-83
	Left			53172-958-000	ATC185S/200/E	81-83
E34-37222	Left	Alloy	N	53172-968-000	ATC110, 125M, ATC200M	
E34-37231	Right	Black	P	52171-HA0-680	ATC125M/250ES	85-87
E34-37241	Right	Alloy	P	53171-VM4-680	TRX125	85-88
				53171-VM6-000	ATC200M/S	85-86
				53171-VM6-680	ATC250ES	85-87
E34-37232	Left	Black	DN	53172-969-680	ATC110, 125M	85
E34-37242	Left	Alloy	DN		ATC200M/S	85
E34-40902	Left	Black	DC	53172-HA0-680	ATC125M	85-87
E34-40912	Left	Alloy	DC	53172-HA0-681	TRX125	85-88
				53172-HA6-000	TRX200SX	86-88
				53171-HA6-680	ATC250ES/SX	85-87
				53171-HA8-680	TRX250	85-87
				53171-HA8-681	TRX300/FW	88
				53171-VM6-000	TRX350/D	87-88
E34-40922	Left	Black	DC	53172-961-000	ATC200X	83-87
	Left				ATC250R	81-86
					TRX250R	86-88
					ATC350X	85-86

LEVER PIN BOLTS

\$.50-J

- Comes complete with nut

FITMENT

Honda
 Yamaha, Suzuki & Kawasaki

PART

E34-73507
 E34-73508



TWO PIECE STYLE LEVER BRACKETS

- Split Two Piece Lever Brackets
- Complete with cable adjusters, nuts, screws & bolts

PART #	FITMENT	OEM	RETAIL
Honda			
E34-37201	Blk. Brake	53171-376-000	\$5.95-J
Kawasaki			
E34-38102	Blk. Clutch KX '90 & up	13091-1680	\$5.95-J
Yamaha			
E34-73801	Blk. Brake	n/a	\$5.95-J
E34-73802	Blk. Clutch	n/a	\$6.50-J



FOREVER LEVER ASSEMBLY

FOREVER LEVER ASSEMBLY

- Deflects upon impact in any direction except towards the handle bars.
- Spring loaded assembly with adjustable tension to allow rider to customize to their riding style.
- Folds away in the event of an accident reducing the chance of being injured by a broken lever.
- Made from the highest quality die cast aluminum.
- Completely serviceable and rebuildable with Aluminum components warranted forever.

Polished Universal Cable Clutch w/Perch	721-0001	\$99.95-H
Black Universal Cable Clutch w/perch	721-0008	\$89.95-H
Black Hydraulic Brake Lever	721-0009	\$77.95-H
Polished Hydraulic Brake Lever	721-0007	\$99.95-H
KTM Hydraulic Polished Brake Lever	721-0022	\$99.95-H

FOREVER LEVER ONLY

Honda CR / XR Clutch Lever	721-0003	\$64.95-H
KTM Polished Clutch Lever	721-0010	\$99.95-H
Hot Start Lever Polished	721-0020	\$51.95-H

REPLACEMENT ITEMS

Offset Perch - Quick Adjust w / Reach Adjuster	721-0004	\$34.95-H
Rebuild Kit	721-0005	\$34.95-H
Race Boot - 2 Packaged	721-0006	\$8.95-H

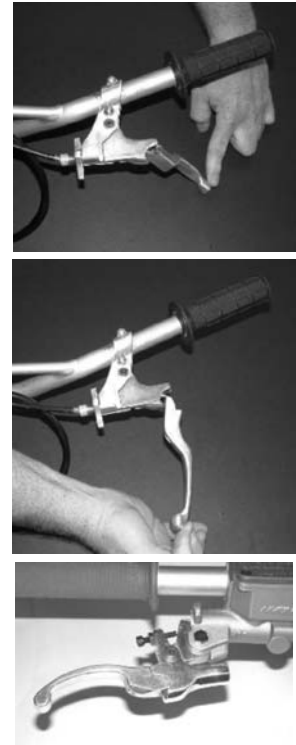

FIRE POWER HYDRAULIC LEVERS

MODEL	DESCRIPTION	PART#	RETAIL
Honda			
XR250 '83-'85	Black	E30-30052	\$5.95-J
XR250 '86-'95	Black	E30-30053	\$8.95-J
XR 600 '85-'00	Black	E30-30053	\$8.95-J
Kawasaki			
KX125, 250,500 '88-'89	Black	E30-30055	\$10.95-J
KDX 200, 250 '88-'94	Black	E30-30055	\$10.95-J
KX 125 '90-'92	Black	E30-30056	\$13.95-J
KX 250'90-'92	Black	E30-30056	\$13.95-J
KX 500'90-'93	Black	E30-30056	\$13.95-J
Suzuki			
RM 125,250, 500/ '89-'95	Blue	E30-30057	\$10.95-J
DR250, 350			
Yamaha			
YZ 125,250, 490/'86-'88	Black	E30-30058	\$13.95-J
IT200, 250/TT350			
YZ 125,250, 250WR'89-'93	Black	E30-30060	\$13.95-J

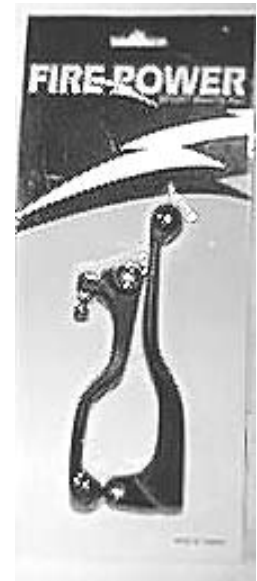

TMV KTM REAR BRAKE SWIVEL HEAD KA6 03

KTM 54813055000 Swivel Head KA6 03
 00250602065 HH Collar Screw M6 x 20 T x 30 mm
 0985060003 Self Lock. Nut DIN0985-M 6

600-0020

\$38.95-J

