

# OPTIMA CLUTCH AND LEVER SET



Lever set (w/ dust boot, nylon mounting bushing, and cable adjuster)



Optima O.T.P Right Hand Hot Shot

## OPTIMA CLUTCH LEVER SET

- Injection molded dust cover and barrel end
- New on-the-fly cable adjuster with spring loaded detent
- Nylon mounting bushing
- New lightweight CNC machined bar clamp
- Top loading hardware
- Extra thick lever pivot
- Hot start button features the same aggressive knurling found on the Optima clutch cable adjuster.



DESCRIPTION/COLOR	TCI #	
Replacement Lever	720-0002	\$28.95-H
Replacement Dust Boot	720-0005	\$5.95-H
Optima O.T.P Right Hand Hot Start Black	720-0003	\$79.95-H



Cable Adjuster

# CLUTCH LEVER ASSEMBLIES



## ROLLER BEARING QUICK ADJUST CLUTCH ASSEMBLY

720-8020

\$99.95-H

- Quick adjust with CNC machined billet clutch perch
- All features of Quick Adjust plus a roller bearing in the lever
- Forged aluminum for lasting durability

Replacement Lever with bearing

720-8021

\$19.95-H

Replacement Cable Adjuster

720-8031

\$9.95-H

Rubber cover

720-8032

\$3.95-H



## TRI-STAR ROLLER BEARING QUICK ADJUST CLUTCH

720-8030

\$109.95-H

- Billet aluminum perch
- New Tri-star shape makes adjusting your clutch during a race even easier
- Spring loaded ball bearings fall into detents for a positive feel
- Sealed roller bearing and tension adjustment in lever makes clutch feel smoother
- Nylon perch bushing

Replacement Lever for Quick Adjust

720-8021

\$19.95-H

Replacement Cable Adjuster

720-8031

\$9.95-H

Replacement Cable Adjuster with Boot

720-8034

\$39.95-H

Replacement Screw, Spring & Ball Kit

720-8033

\$5.95-H



## EZ PULL CLUTCH REPLACEMENT LEVER FOR 56-6465

720-8011

\$9.95-H

- Honda style lever
- Forged aluminum for lasting durability



## QUICK ADJUST CLUTCH REPLACEMENT PARTS FOR 56-6460

- Honda style lever

Replacement Lever for Quick Adjust

720-8001

\$12.95-H

Rubber Cover

720-8032

\$3.95-H

Replacement Cable Adjuster

720-8031

\$9.95-H

## FOREVER LEVER ASSEMBLY

### FOREVER LEVER ASSEMBLY

- Deflects upon impact in any direction except towards the handle bars.
- Spring loaded assembly with adjustable tension to allow rider to customize to their riding style.
- Folds away in the event of an accident reducing the chance of being injured by a broken lever.
- Made from the highest quality die cast aluminum.
- Completely serviceable and rebuildable with Aluminum components warranted forever.

Polished Universal Cable Clutch w/Perch	721-0001	\$99.95-H
Black Universal Cable Clutch w/perch	721-0008	\$89.95-H
Black Hydraulic Brake Lever	721-0009	\$77.95-H
Polished Hydraulic Brake Lever	721-0007	\$99.95-H
KTM Hydraulic Polished Brake Lever	721-0022	\$99.95-H

### FOREVER LEVER ONLY

Honda CR / XR Clutch Lever	721-0003	\$64.95-H
KTM Polished Clutch Lever	721-0010	\$99.95-H
Hot Start Lever Polished	721-0020	\$51.95-H

### REPLACEMENT ITEMS

Offset Perch - Quick Adjust w / Reach Adjuster	721-0004	\$34.95-H
Rebuild Kit	721-0005	\$34.95-H
Race Boot - 2 Packaged	721-0006	\$8.95-H

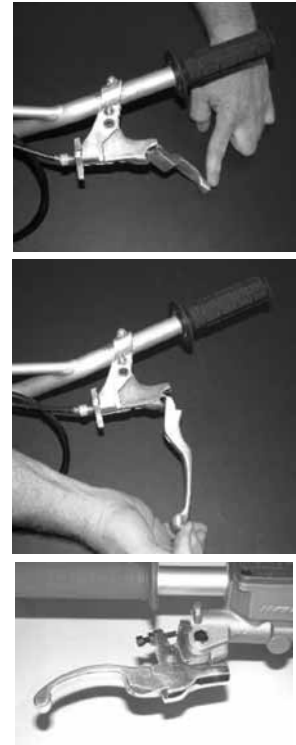

## FIRE POWER HYDRAULIC LEVERS

MODEL	DESCRIPTION	PART#	RETAIL
<b>Honda</b>			
XR250 '83-'85	Black	E30-30052	\$5.95-J
XR250 '86-'95	Black	E30-30053	\$8.95-J
XR 600 '85-'00	Black	E30-30053	\$8.95-J
<b>Kawasaki</b>			
KX125, 250,500 '88-'89	Black	E30-30055	\$10.95-J
KDX 200, 250 '88-'94	Black	E30-30055	\$10.95-J
KX 125 '90-'92	Black	E30-30056	\$13.95-J
KX 250'90-'92	Black	E30-30056	\$13.95-J
KX 500'90-'93	Black	E30-30056	\$13.95-J
<b>Suzuki</b>			
RM 125,250, 500/ '89-'95	Blue	E30-30057	\$10.95-J
DR250, 350			
<b>Yamaha</b>			
YZ 125,250, 490/'86-'88	Black	E30-30058	\$13.95-J
IT200, 250/TT350			
YZ 125,250, 250WR'89-'93	Black	E30-30060	\$13.95-J

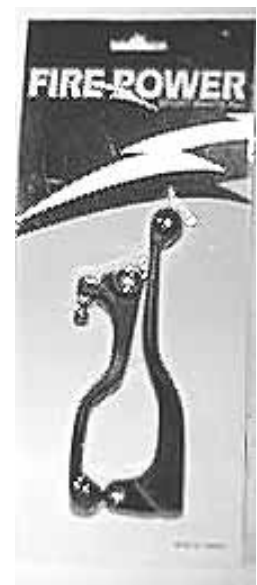

## LEVERS & BRACKETS



MODEL	DESCRIPTION	PART#	RETAIL
<b>Honda</b>			
Bracket & Lever Control Assembly	Black/Black	E32-73600	\$21.95-J
<b>Honda XR</b>			
Alloy	E30-73660	\$9.95-J	
Black	E30-73662	\$11.95-J	



### GP SHORT LEVER CONTROL ASSEMBLIES

- Black competition lever control sets

DESCRIPTION	PART #	RETAIL
Honda Lever Assembly (pair)	E32-73600	\$21.95-J
Lever Long Chrome/Aluminum Pair	720-455	\$5.95-J

## LEVERS



MODEL	DESCRIPTION	PART#	RETAIL
<b>Suzuki</b>			
GN400T '82	Clutch	E30-79452	\$4.95-J
GN805G '83	Clutch	E30-79452	\$4.95-J

### Harley Davidson

Big Twin & XL Models '82-93	Brake & Clutch	E07-89030	\$27.95-J
-----------------------------	----------------	-----------	-----------

### GP SHORT LEVER SETS

- Competition short style lever sets
- Available in two finishes - black or polished



DESCRIPTION	PART #	RETAIL
Honda XR Polished	E30-73660	\$9.95-J
Honda XR Black	E30-73662	\$11.95-J
Suz OEM 57300/57420-49100 Black	E30-64801	\$4.95-J



### KAWASAKI LEVER BLADES 720-501 \$11.95-J

- Replacement blades constructed of lightweight composite Plastic material
- Will fit all Japanese non-hydraulic motorcycles
- Black
- Sold in pairs

## EMGO DIRT LEVERS

Model	Year(s)	Clutch	Brake
<b>Honda</b>			
XR80R	85-95	E30-24002	
XR100R	85-95	E30-24002	
XR 200	80-84	E30-24002	
XR 200R	81-95	E30-24002	
XR 250/R	80-82	E30-24002	
XR 250R	83-85	E30-24002	
XR 250R	86-95	E30-24002	
XR 350R	1983/85	E30-24002	
XR 350R	1984	E30-24002	
XR 350R	1985	E30-24002	
XR 500R	80-84	E30-24002	
XL 600L	89-90	E30-24002	
XR 600R	85-00	E30-24002	
<b>Kawasaki</b>			
KX 80E1	83	E30-32912	E30-32911
KX80	84-95	E30-32912	
	96-97	E30-32912	E30-32991
	97-00		E30-32991
KX 100	94-95	E30-32912	
	96-97	E30-32912	E30-32991
	98-99		E30-32991
KLX 125	84-04	E30-32912/F	
KX 125	82-89	E30-32912	
	97-99		E30-32991
KDX 175	80-81	E30-32912	E30-32911
KDX 200	83-85	E30-32912	E30-32911
	86-07	E30-32912	
KDX 220	84-04	E30-32912/F	
KDX 250	82-84	E30-32912	E30-32911
	91-94	E30-32912	
KL 250	83-84	E30-32912	E30-32911
KLX 250	94-96	E30-32912	
KX 250	82-89	E30-32912	
	97-99		E30-32991
KXT 250	82-83,85	E30-32912	
KLX 300	96-04	E30-32912/F	
KLX 400	03-04	E30-32912/F	
KDX 450	82	E30-32912	E30-32911
KX 500	83-89	E30-32912	
	97-03		E30-32991
KLX 650	96	E30-32912	

Model	Year(s)	Clutch	Brake
<b>Suzuki</b>			
RM 80	86-88	E30-79452	
DR 100	83-89	E30-79452	
DR 125	82-88	E30-79452	
RM 125	85-88	E30-79452	
RM 250	85-88	E30-79452	
DR650 S/SE	90-93	E30-79452	
<b>Yamaha</b>			
YZ 50	80		E30-51161
BW 80	86-88		E30-51161
PW 80 Zinger	95-06		E30-51161
YZ 80	79-85		E30-51161
TTR90	06-09		E30-51161
MX 100	81-83		E30-51161
RT 100	89-97		E30-51161
YZ 100	75-83		E30-51161
IT 125	80-81		E30-51161
YZ 125	78-82		E30-51161
	83-84		E30-51161
DT 175	78-81	E30-51222	
IT 175	79-83		E30-51161
MX 175	81		E30-51161
RT 180	90-93		E30-51161
BW 200	86-88		E30-51161
TW 200	00-04		E30-51161
TW 200 Trailway	87-95		E30-51161
XT 225	97-05		E30-51161
DT 250	79-81	E30-51222	
IT 250	79-83		E30-51161
TT 250	80-82		E30-51161
YZ 250	78-84		E30-51161
BW 350	87-88		E30-51161
TY350 Trails	85-86		E30-51161
IT 465	81-82		E30-51161
YZ 465	80-81		E30-51161
IT 490	83-84		E30-51161
YZ 490	82-84		E30-51161
XT 500	79-81	E30-51222	
TT 600	83-84		E30-51161



On Line Ordering available at [www.transcanimports.com](http://www.transcanimports.com)

Place an order, view stock, check out suggested retail pricing.

View the latest versions of our catalogues at [www.transcanimports.com](http://www.transcanimports.com)

And click on the icon of the catalogue you wish to view



## EMGO ATV LEVERS

Model	Year(s)	Clutch	Brake
<b>Honda</b>			
TRX90	93-01	E30-27081	
ATC110	83	E30-27001	
	84	E30-27091	
	85	E30-27081	
ATC125M	84	E30-27091	E30-27002
	85-86	E30-27081	E30-27012
	87		E30-27002
TRX125	85		E30-27012
TRX125 Four Trax	85-88		E30-27002
ATC185/S	80-82		E30-26411
	83	E30-27001	E30-27002
ATC200/E	81-82		E30-26411
	83	E30-27001	E30-27002
ATC200ES Big Red	84	E30-27091	E30-27002
ATC200M/S	84	E30-27091	E30-27002
	85-86	E30-27081	E30-27012
ATC200X	83-87	E30-27021	E30-27031
TRX200/D	84,90-97		E30-27032
TRX200SX	86-88	E30-27021	E30-27032
ATC250ES Big Red	85		E30-27012
ATC250R	81-86	E30-24002	E30-27031
ATC250SX	85-87	E30-27051	E30-27022
TRX250	85-86	E30-27051	E30-27032
TRX250 Four Trax	85-87	E30-27051	E30-27032
TRX250R	86-89		E30-27021
TRX250 Recon	97-01	E30-27051	
TRX250EX	01-05	E30-27051	E30-27032
TRX250TE/TM	02-05	E30-27051	
TRX300/FW	96-00	E30-27051	
TRX300	99-00	E30-27051	E30-27032
TRX300EX	93-05		E30-27032
TRX350FE/FM	04-05	E30-27051	E30-27032
TRX350TE/TM	04-05	E30-27051	E30-27032
ATC350X	84-87	E30-27021	E30-27031
TRX350/D	86-88	E30-27051	
TRX400EX	99-05		E30-27032
TRX400FW	95-03	E30-27051	E30-27032
TRX450ES	98-00	E30-27051	E30-27032
TRX450FE/FM	98-04	E30-27051	E30-27032
TRX450S	98-00	E30-27051	E30-27032
<b>Kawasaki</b>			
KLT200C	84	E30-32912	E30-32911
KLT250 C2-C3	84-85	E30-32912	
KX250	97-98		E30-32991
KXT250A Tecate	84	E30-32912	E30-32911
KXT250 A2/B1	85-86	E30-32912	
KXT250 B2 Tecate	87-88	E30-32912	

Model	Year(s)	Clutch	Brake
<b>Suzuki</b>			
LT230GE	86-89	E30-64812	E30-64811
LT230E	87-90	E30-64812	E30-64811
	91-93	E30-64812	
LT230S	85-89	E30-64812	E30-64811
LT-F230	86-87		E30-64811
LT-F230E Quadrunner	1985		E30-64801
LT250EF	85-86		E30-64801
LT250R	85-91	E30-64812	E30-64811
LT250S	89-90	E30-64812	E30-64811
LT-F250	88-90	E30-79452	E30-64811
	91-92	E30-79452	
LT300E	87-89		E30-64811
LT4WD	87-91	E30-79452	
LT4WDH	87-93	E30-79452	E30-64801
LT500R	87-90	E30-64812	E30-64801
<b>Yamaha</b>			
YFM80 Moto-4	87-88		E30-51181
YFM100 Champ	87-89		E30-51181
YFM125GHX Grizzly 125	05-09		E30-51181
YFM200 Moto-4	83-85		E30-51161
YFM200DX	86-91		E30-51181
YFS200 Blaster	88-93	E30-51152	
YFAIK Breeze	99-03		E30-51181
YTM200 Tri-Moto	83-85		E30-51161
YFM225 Moto-4	86-88		E30-51181
YTM225 Tri-Moto	83-85		E30-51161
YFB250 Timberwolf	94-00		E30-51181
YFM250X	99-04		E30-51181
YTZ250 Tri-Moto	85-86		E30-51181
YFM350FR Moto-4	87-88		E30-51181
YFM350FW Big Bear	87-99		E30-51121
YFM350FX Wolverine	95-98	E30-51152	
YFM350X Warrior	98-05	E30-51152	
YFP350 Terrapro	88		E30-51181
YFZ350 Banshee	87-03	E30-51152	
YFM350 Timberwolf	96		E30-51121
YFM400FW Kodiak	94-98		E30-51121
YFM600 Grizzly	98-01		E30-51121

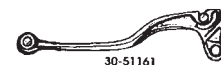
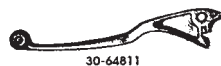
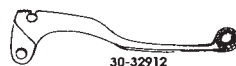

## LEVER PERCHS



### SPLIT PERCH LEVER BRACKETS

- Replacement lever brackets for Honda ATV's.
- Complete with cable adjusters, nuts, screws and bolts.

**KEY:**

*P = No parking brake notch*  
*N = Single brake pin notch*  
*DN = Double brake pin notch*  
*DC = Dual cable type bracket*

EMGO #	SIDE	TYPE	KEY	OEM REF.	APPLIC.	YEAR
E34-37211	Right	Alloy	P	53171-958-000	ATC185/S/200	80-83
				53171-958-010	ATC200E/ES/M	82-84
E34-37212	Left	Alloy	DN	53172-918-000	ATC90/110/185	70-83
	Left			53172-958-000	ATC185S/200/E	81-83
E34-37222	Left	Alloy	N	53172-968-000	ATC110, 125M, ATC200M	
E34-37231	Right	Black	P	52171-HA0-680	ATC125M/250ES	85-87
E34-37241	Right	Alloy	P	53171-VM4-680	TRX125	85-88
				53171-VM6-000	ATC200M/S	85-86
				53171-VM6-680	ATC250ES	85-87
E34-37232	Left	Black	DN	53172-969-680	ATC110, 125M	85
E34-37242	Left	Alloy	DN		ATC200M/S	85
E34-40902	Left	Black	DC	53172-HA0-680	ATC125M	85-87
E34-40912	Left	Alloy	DC	53172-HA0-681	TRX125	85-88
				53172-HA6-000	TRX200SX	86-88
				53171-HA6-680	ATC250ES/SX	85-87
				53171-HA8-680	TRX250	85-87
				53171-HA8-681	TRX300/FW	88
				53171-VM6-000	TRX350/D	87-88
E34-40922	Left	Black	DC	53172-961-000	ATC200X	83-87
	Left				ATC250R	81-86
					TRX250R	86-88
					ATC350X	85-86

### LEVER PIN BOLTS

\$ .50-J

- Comes complete with nut

**FITMENT**

Honda  
 Yamaha, Suzuki & Kawasaki

**PART #**

E34-73507  
 E34-73508



### TWO PIECE STYLE LEVER BRACKETS

- Split Two Piece Lever Brackets
- Complete with cable adjusters, nuts, screws & bolts

PART #	FITMENT	OEM	RETAIL
<b>Honda</b>			
E34-37201	Blk. Brake	53171-376-000	\$5.95-J
<b>Kawasaki</b>			
E34-38102	Blk. Clutch KX '90 & up	13091-1680	\$5.95-J
<b>Yamaha</b>			
E34-73801	Blk. Brake	n/a	\$5.95-J
E34-73802	Blk. Clutch	n/a	\$6.50-J





# TMV SHIFT LEVERS

## TMV GEAR SHIFT LEVERS

\$37.95

- Forged aluminum that's tougher and less expensive than stock.
- Perfect OEM fit.
- Hinged shift tip folds back on impact.
- Satin anodized finish resists corrosion.

APPLICATION	YEAR	PART	COLOR	APPLICATION	YEAR	PART	COLOR
<b>GasGas</b>				<b>KTM</b>			
	'98+	600-1050	Silver	65 SX	'98-07	600-1042	Orange
<b>Honda</b>				65 SX	'98-07	600-1043	Silver
CR 80R	'96-02	600-1002	Red	65 SX	'09-18	600-1048	Orange
CR 80R	'96-02	600-1003	Silver	65 SX	'09-18	600-1049	Silver
CR 85R	'03-07	600-1002	Red	85 SX	'03-18	600-1044	Orange
CR 85R	'03-07	600-1003	Silver	85 SX	'03-18	600-1045	Silver
CR 125R	'87-07	600-1004	Red	105 SX	'04-11	600-1044	Orange
CR 125R	'87-07	600-1005	Silver	105 SX	'04-11	600-1045	Silver
CRF 150R	'07-18	600-1000	Red	125 EXC 2-stroke	'01-16	600-1036	Orange
CRF 150R	'07-18	600-1001	Silver	125 EXC 2-stroke	'01-16	600-1037	Silver
CR 250	'84-01	600-1006	Red	125 SX 2-stroke	'01-15	600-1036	Orange
CR 250	'02-07	600-1009	Red	125 SX 2-stroke	'01-15	600-1037	Silver
CR 250	'02-07	600-1010	Silver	144 SX 2-stroke	'07-08	600-1036	Orange
CR 250F	'04-09	600-1013	Red	144 SX 2-stroke	'07-08	600-1037	Silver
CR 250F	'04-09	600-1014	Silver	150 SX 2-stroke	'09-15	600-1036	Orange
CR 250F	'10-17	600-1038	Red	150 SX 2-stroke	'09-15	600-1037	Silver
CR 250F	'10-17	600-1039	Silver	200 EXC 2-stroke	'01-16	600-1036	Orange
CR 450F	'02-04	600-1013	Red	200 EXC 2-stroke	'01-16	600-1037	Silver
CR 450F	'02-04	600-1014	Silver	250 EXC-F 4-stroke	'12-16	600-1040	Orange
CR 450F	'05-08	600-1007	Red	250 EXC-F 4-stroke	'12-16	600-1041	Silver
CR 450F	'05-08	600-1008	Silver	250 SX-F 4-stroke	'11-12	600-1040	Orange
CR 450F	'09-18	600-1011	Red	250 SX-F 4-stroke	'11-12	600-1041	Silver
CR 450F	'09-18	600-1012	Silver	250 SX-F 2-stroke	'13-15	600-1036	Orange
CR 450RX	'17-18	600-1011	Red	250 SX-F 2-stroke	'13-15	600-1037	Silver
CR 450RX	'17-18	600-1012	Silver	300 EXC 2-stroke	'01-03	600-1036	Orange
<b>Husqvarna</b>				300 EXC 2-stroke	'01-03	600-1037	Silver
TC 65	'17-18	600-1049	Silver	350 EXC-F 4-stroke	'12-16	600-1040	Orange
TC 85	'15-18	600-1045	Silver	350 EXC-F 4-stroke	'12-16	600-1041	Silver
TC 125	'14-15	600-1036	Silver	350 SX-F 2-stroke	'11-15	600-1036	Orange
TE 125	'14-16	600-1036	Silver	350 SX-F 2-stroke	'11-15	600-1037	Silver
FE 250/350/450	'14-16	600-1041	Silver	350 SX-F 4-stroke	'11-16	600-1040	Orange
FC 350	'14-16	600-1041	Silver	350 SX-F 4-stroke	'11-16	600-1041	Silver
FC 450	'14-15	600-1041	Silver	450 EXC-F 4-stroke	'03-16	600-1040	Orange
FS 450	'14-16	600-1041	Silver	450 EXC-F 4-stroke	'03-16	600-1041	Silver
FE 501	'14-16	600-1041	Silver	450 SX-F 4-stroke	'03-06/13-15	600-1040	Orange
<b>Kawasaki</b>				450 SX-F 4-stroke	'03-06/13-15	600-1041	Silver
KX 125	'94-08	600-1015	Silver	450 SX-F 2-stroke	'07-11	600-1036	Orange
KX 250	'94-08	600-1015	Silver	450 SX-F 2-stroke	'07-11	600-1037	Silver
KX 250F	'06-08	600-1017	Silver	500/525/530 EXC-F	'05-16	600-1040	Orange
KX 250F	'09-18	600-1047	Silver	500/525/530 EXC-F	'05-16	600-1041	Silver
KX 450F	'06-08	600-1016	Silver	<b>Yamaha</b>			
KX 450F	'09-15	600-1046	Silver	YZ 80	'83-01	600-1035	Silver
<b>Suzuki</b>				YZ 85	'02-18	600-1035	Silver
RM85	'02-18	600-1022	Silver	YZ 125/250	'96-04	600-1023	Blue
RM125	'89-09	600-1021	Gold	YZ 125/250	'96-04	600-1024	Silver
RM250	'89-08	600-1021	Gold	YZ 125/250	'05-18	600-1025	Blue
RMZ250	'04-06	600-1019	Silver	YZ 125/250	'05-18	600-1026	Silver
RMZ250	2007	600-1018	Silver	WR 250F	'01-16	600-1031	Blue
RMZ250	'08-18	600-1033	Blue	WR 250F	'01-16	600-1032	Silver
RMZ250	'08-18	600-1034	Silver	YZ 250F	'01-18	600-1031	Blue
RMZ450	'05-07	600-1020	Silver	YZ 250F	'01-18	600-1032	Silver
RMZ450	'08-18	600-1029	Blue	YZ 450F	'03-13	600-1027	Blue
RMZ450	'08-18	600-1030	Silver	YZ 450F	'03-13	600-1028	Silver

## FOLDING GEAR SHIFT LEVERS

- Replacement shift levers that fold to help prevent bending & breakage of the shifter shaft and lever
- Blister packed

1 - Folding Shift Lever 2 - Heel/Toe Shift Lever 3 - Folding Lever 4. Forged Shift Lever

DESCRIPTION	YEAR	PART #	TYPE	RETAIL
<b>Honda</b>				
CR 125	'90-'97	E83-88086	3	\$14.95-J
CR 125	'87-88	E83-88040	3	\$14.95-J
TRX250	'86-89	E83-88043	1	\$13.95-J
TRX 300	'88-91/'96-00	E83-88042	1	\$16.95-J
TRX 300/FW	'92-00	E83-88048	2	\$16.95-J
TRX 350 EX		E83-88043	1	\$13.95-J
TRX 400	'95-98	E83-88044	1	\$14.95-J
TRX 400EX	'99-07	E83-88046	1	\$14.95-J
TRX 400	'99-01	E83-88047	2	\$14.95-J
TRX 400 FM	'95-02	E83-88047	2	\$14.95-J
TRX 400 FW	'95-'03	E83-88047	2	\$14.95-J
TRX 450 FE/FM	98-05	E83-88047	2	\$14.95-J



<b>KAWASAKI</b>				
KX 60	'83-03	E83-88050	1	\$14.95-J
KX 80	'83-90	E83-88050	1	\$14.95-J
KX 125	'83-93	E83-88050	1	\$14.95-J
KX 125	'94-02	E83-88052	1	\$14.95-J
KX125/KX250	'83-93	E83-88051		\$14.95-J
KLF 220 Bayou	'89-02	E83-88053	1	\$16.95-J
KLF 250 Bayou	'03-07	E83-88053		\$16.95-J
KX 250	'84-93	E83-88050	1	\$14.95-J
KX 250	'94-02	E83-88052	1	\$14.95-J
KX 500	'87-93	E83-88050	1	\$14.95-J
KX 500	'94-04	E83-88052	1	\$14.95-J

<b>SUZUKI</b>				
RM 100	'76-81	E83-88083	1	\$14.95-J
RM 125	'75-80	E83-88083	1	\$14.95-J
PE 250	'80-81	E83-88085	1	\$14.95-J
RM 250	'80-85	E83-88085	1	\$14.95-J
RM 370	'76-77	E83-88083	1	\$14.95-J
RM 400	'78-80	E83-88083	1	\$14.95-J
RM 465	'81-83	E83-88085	1	\$14.95-J
RM 500	83-84	E83-88085	1	\$14.95-J
GXSR 600	'92-93	E83-88012	4	\$49.95-J

<b>YAMAHA</b>				
IT/MX/YZ		E83-88082	1	\$14.95-J
YFM 250	'99	E83-88077	1	\$14.95-J
YFM 350 Big Bear 2WD	'93-98	E83-88079	2	\$16.95-J
YFM 350 Big Bear 4WD	'93-99	E83-88078	2	\$19.95-J
YFM 400 Kodiak 2WD	'93-98	E83-88079	2	\$16.95-J
YFM 400 Kodiak 4WD	'93-99	E83-88078	2	\$19.95-J

## NON-FOLDING GEAR SHIFT LEVERS

### EMGO UNIVERSAL NON-FOLDING SHIFT LEVER

E83-88010

\$8.95-J

Fits: Honda CB 750 up to 1978/CB 500/XL 80/XL 100/XL 200/XL 250/XL 500R / XL 500S  
 Kawasaki K 100  
 Suzuki GS 750 E/GS 750 L/GS 850/GS 1000/GS 1100G / GS1100GK  
 Yamaha 650 Maxim/XS 1100





Model	Year(s)	Part#
<b>Honda</b>		
XL250R	81-83	E83-61611
XL250R	84-87	E83-61612
XL250S	78-81	E83-61611
XR250	79-80	E83-61611
XR250R	84-91	E83-61612
XL350R	84-85	E83-61612
XR350R	83-84	E83-61612
XL500R	82	E83-61612
XL500S	79-81	E83-61612
XR500R	83-84	E83-61612
XL600R	82-86	E83-61612

Model	Year(s)	Part#
<b>Kawasaki</b>		
KE124	80-83	E83-61640
KDX175	80-82	E83-61640
KE175	80-83	E83-61640
KDX250	80-83	E83-61640
KL250	78-83	E83-61640
KLX250	79-80	E83-61640
KX250	80-86	E83-61640

## DAYTONA RACING PRODUCTS

### SHINDY STEERING DAMPER KIT

- Kits include an individual length of stabilizer and complete bolt-on brackets without rivet mounting for easy and secure installation.

Application	Year	Mounting Place	TCl#	Retail
<b>Honda</b>				
NT650 Hawk GT	88-90	Left Hand Side	712-2104	\$299.95-H
CBR600F3	95-98	Inside of Fairing	712-2107	\$299.95-H
CBR600F2	91-94	Inside of Fairing	712-2107	\$299.95-H
CBR900RR	93-97	Inside of Fairing	712-2108	\$269.95-H
CBR900RR	98-99	Inside of Fairing	712-2112	\$299.95-H
CBR600F4	99-00	Left Hand Side	712-2115	\$399.95-H
CBR600F4i	01-04	In Front of Gas Tank	712-2115	\$399.95-H
<b>Kawasaki</b>				
ZX750M ZX-7R	93-94	Right Hand Side	712-2206	\$379.95-H
ZX750L ZX-7	93-95	Right Hand Side	712-2206	\$379.95-H
ZX-6R	95-97		712-2207	\$299.95-H
ZX600G ZX-6R	98-99	Inside of Fairing	712-2208	\$359.95-H
ZX900C ZX-9R	98-99	Inside of Fairing	712-2208	\$359.95-H
<b>Suzuki</b>				
GSXR750	85-87		712-2301	\$239.95-H
GSXR750	00-02	Inside of Fairing	712-2309	\$359.95-H
GSXR1000	02	Inside of Fairing	712-2309	\$359.95-H
<b>Yamaha</b>				
VMX12 V-Max	85-92	Left Hand Side	712-2406	\$299.95-H
VMX12 V-Max	93-05	Left Hand Side	712-2408	\$299.95-H
YZF-R6	99-02	Inside of Fairing	712-2410	\$399.95-H



### SHINDY ONE PIECE LIGHTWEIGHT FORK BRACKETS

\$55.95-H

- For mounting steering stabilizer to the fork tube.
- Lightweight one-piece brackets machined from billet aluminum.

FORK SIZE	PART #
36 mm	712-2502
41 mm	712-2506
42 mm	712-2507

### SHINDY BUELL STABILIZER MOUNTING BRACKETS

712-3251

\$199.95-H

- Buell S1 / 2 / 2T / 3 / 3T '95-98

### DAYTONA STABILIZER PARTS

712-3002

\$31.95-H

- Individual replacement parts for both oval and round type steering stabilizers