

## WINDSHIELD INFO

### OEM Style

These windshields are made by a leading OEM supplier with GE Lexan Polycarbonate, the strongest material available. Our high quality windshields are a good investment for your store yielding strong profits and customer satisfaction and the highest optical quality available.

### Standard Style

Windshields are heavier than most OEM models, yet stay flexible at sub-zero temperatures. Most formed windshields feature a spoiler (air-flip) which helps protect the rider from the wind. Windshields are finished with a black trim around the outer edge and come shrink-wrapped so your customers receive an unmarked, quality product.

- Windshield measurements are top center to bottom. This does not include any mounting tabs.
- **NO returns accepted if plastic covering is removed from windshield**

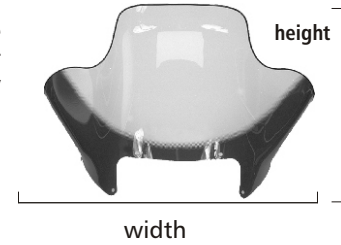

## ARCTIC CAT WINDSHIELDS

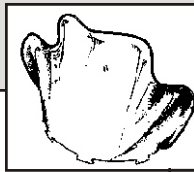

### Pantera, Prowler Style Hood

#### A/C Chart 1

DESCRIPTION	OEM	TCI #
High Smoke 18"	0606-722	761-1252
Low Clear 12.5"	0606-611	761-1251

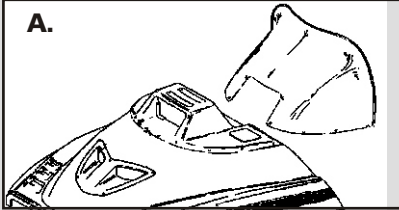

### A. Original Wildcat Style Hood

#### A/C Chart 2

DESCRIPTION	OEM	TCI #
Low Black 13.5"	0606-181	761-1260
Std. Purple 10"		761-1264
Std. A/C Green 10"		761-1267

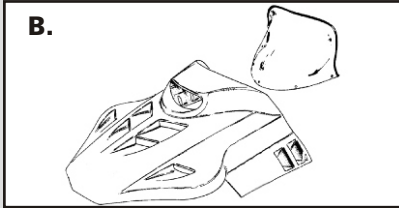

### B. Wildcat 2 Style Hood

DESCRIPTION	OEM	TCI #
Std. Smoke 10"	0606-999	761-1340

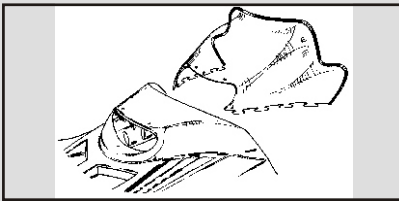

### Thundercat / Wildcat Hood

#### A/C Chart 3

DESCRIPTION	OEM	TCI #
Mid A/C Smoke 10"		761-1337

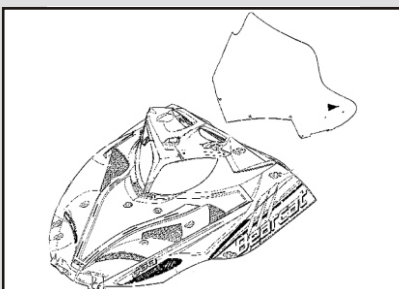

### Firecat 2

#### A/C Chart 4

DESCRIPTION	OEM	TCI #
High Clear 17"	3639-906	761-1521

## ARCTIC CAT WINDSHIELDS

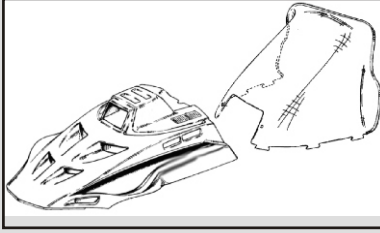

### Jag Style Hood - (3 tabs)

A/C Chart 5

DESCRIPTION	OEM	TCI #
High Smoke 19"	0606-839	761-1382
Purple 10"	0616-154	761-1384
Black 10"	0616-154	761-1389

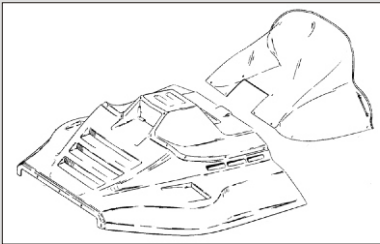

### Lynx MC Style Hood

A/C Chart 6

DESCRIPTION	OEM	TCI #
Mid Smoke 19"	0606-411	761-1290
Mid Clear 19"	0606-780	761-1291

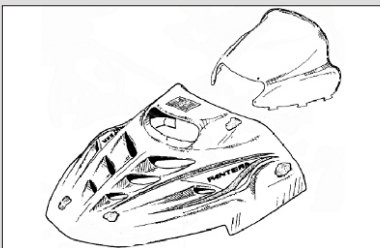

### Original ZRT Chassis Style Hood

A/C Chart 7

DESCRIPTION	OEM	TCI #
Mid Smoke 17 x 33" Wide	0616-537	761-1391
Low Smoke 13"	0638-831	761-1392

Flared Yellow 17" x 34"		761-1991
Flared Purple 17" x 34"		761-1994

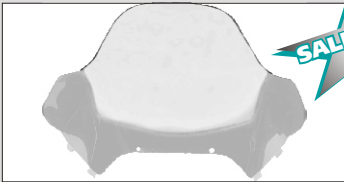

### Flared Windshield

Flared windshield for head and body protection with colored silk screen bottom.

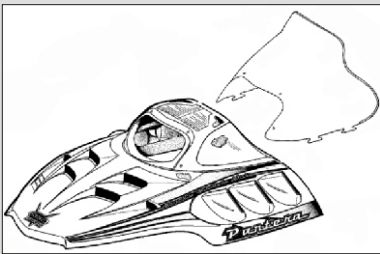

### ZRT 2 Chassis Hood Style

A/C Chart 8

DESCRIPTION	OEM	TCI #
Cobra Low 13" Blk w/white checks		619-1030

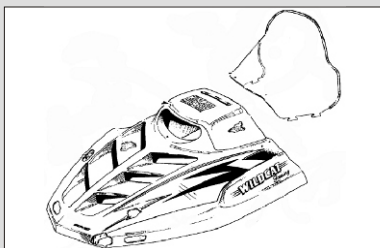

### Original ZR Chassis Style Hood

A/C Chart 9

DESCRIPTION	OEM	TCI #
Std. Smoke 16"	0616-361	761-1310
Mid Black 14"	0638-399	761-1319
High Clear 20"	0616-907	761-1311

Flared Yellow 17" x 34"		761-1981
-------------------------	--	----------



**ARCTIC CAT WINDSHIELDS**

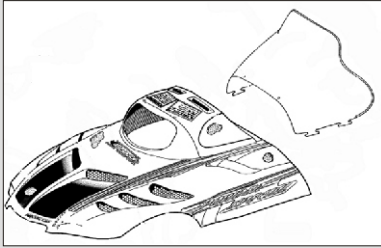

**ZR 2 Chassis Style Hood**

A/C Chart 10

DESCRIPTION	OEM	TCI #
Mid Smoke 16 x 29"	1606-074	761-1440

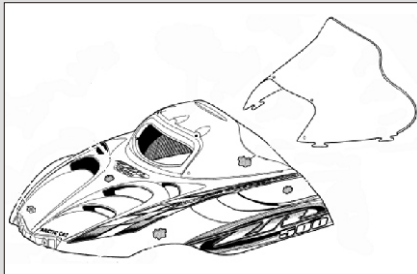

**ZR 3 Chassis 3rd Generation Style Hood**

A/C Chart 11

DESCRIPTION	OEM	TCI #
Mid Smoke 15	1606-696	761-1480
Low Smoke 13	1639-572	761-1481

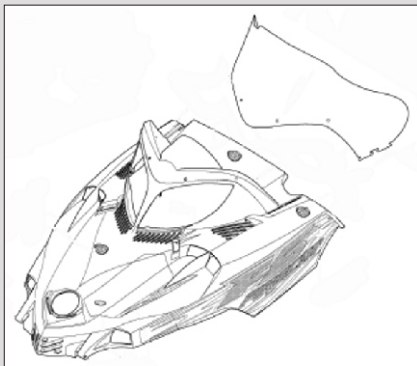

**Firecat Series - (ZR 4 Chassis 4th Generation Hood Style)**

A/C Chart 12

DESCRIPTION	OEM	TCI #
Low Smoke 10"	2639-632	761-1500
Mid Smoke 13"	2639-634	761-1501

Cobra Extra Low 7" Transparent Org Tint 619-1064  
 Cobra Low 14.25" Chr w/diamond plate graphics 619-1066



619-1066

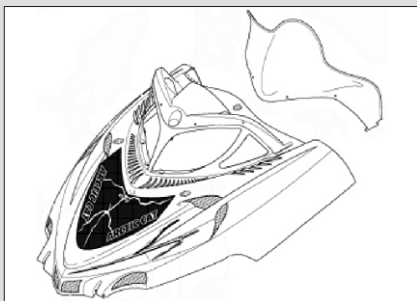

**M Series - (ZR 4 Chassis 4th Generation Hood Style)**

Fits 2005-11 M1(1000)M5,M6,M7,M8, 2006-11 Crossfire

A/C Chart 13

DESCRIPTION	OEM	TCI #
Cobra Low 14" Black		619-1005
Cobra Mid 17" Black		619-1006



619-1005

## ARCTIC CAT WINDSHIELDS

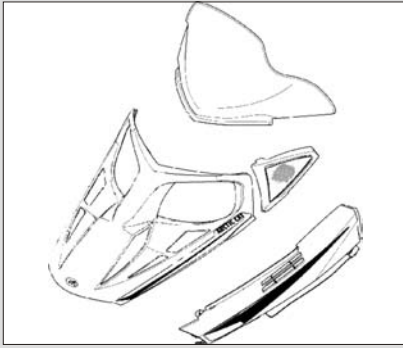
**F Series (Original F Chassis)**  
**A/C Chart 14**

## DESCRIPTION

Cobra Mid 14.75" Tint w/black graphics  
 Cobra Mid 14.75" Black w/Blackgraphics  
 Cobra High 16.5" Clear w/black graphics

## TCI #

619-1081  
 619-1082  
 619-1080



619-1082



619-1080

## ARCTIC CAT WINDSHIELD APPLICATIONS

Model	Year	TCI PART #	OEM # / hood Style	H x W	Color
Bearcat 340, 440, 550	95-00	Arctic Cat Chart #9	ZR1 Style Hood		
Bearcat Widetrack	95-02	Arctic Cat Chart #9	ZR1 Style Hood		
Bearcat Widetrack, 570	03-08	Arctic Cat Chart #11	ZR3 Style Hood		
Bearcat 660 WT-Turbo	06-08	Arctic Cat Chart #4	Firecat 2 Style Hood		
Bearcat	08-14	Arctic Cat Chart #14	Original F Chassis		
Cheetah 340, 399, 440	1972	761-1040	0116-313	15	Smoke
Cheetah C-340, C-440, C-436	1973	761-1050	0106-440	13	Smoke
Cheetah 340, 440	74-75	761-1050	0106-440	13	Smoke
Cheetah 295	1975	761-1050	0106-440	13	Smoke
Cheetah F/C, L/C, Std	86-89	761-1150 761-1151	0606-049 0606-043	15 M 21 H	Smoke Smoke
Cheetah Touring F/C	1988	761-1300	0606-565	18 1/2 H	Smoke
Cheetah, Touring	89-94	Arctic Cat Chart #6	Lynx MC Style Hood		
Cougar, SE, MC	1985	761-1150 761-1151	0606-049/0606-008 0606-043	15 M 21 H	Smoke Smoke
Cougar	86-88	761-1300	0606-385	18 1/2 H	Smoke
Cougar Std., 2-up	89-92	Arctic Cat Chart #6	Lynx MC Style Hood		
Cougar	93-94	Arctic Cat Chart #5	Jag Style Hood		
Cougar	95-98	Arctic Cat Chart #7	ZRT Style Hood		
Crossfire (all)	06-11	Arctic Cat Chart #13	M-Series ZR4 Style Hood		
El Tigre 250, 340, 400, 440	73-74	761-1060	0116-369	10	Smoke
El Tigre 340, 440, 500, 4000, 5000, Z	75-77	761-1090	0116-826	11	Smoke
El Tigre 5000, 6000	78-84	761-1160	0106-937	13	Smoke
El Tigre 5000, 6000	85-88	761-1150 761-1151	0606-049 0606-043	15 M 21 H	Smoke Smoke
El Tigre EXT, MC	89-91	Arctic Cat Chart #2	Wildcat Style Hood		
EXT (all FA-2 and FA-3)	72-74	761-1060	0116-369	10	Smoke
EXT 550 & 580 Z/ EFI/ MC	1993	760-1350.so	0616-262		
EXT 580, EFI, MC	94-98	Arctic Cat Chart #9	ZR1 Style Hood		
EXT Powder Special	1995	Arctic Cat Chart #9	ZR1 Style Hood		
EXT 600, Deluxe	97-98	Arctic Cat Chart #7	ZRT Style Hood		
EXT 600 Powder Extreme	1997	Arctic Cat Chart #7	ZRT Style Hood		
EXT Special, 550 MC	91-92	Arctic Cat Chart #1	Pantera/Prowler oe 0606-722		
F-Series	07-14	Arctic Cat Chart #14	Original F Chassis		
Firecat F5, Sno Pro	03-06	Arctic Cat Chart #12	Firecat Series - ZR4 Style Hood		
Firecat F6, Sno Pro, EFI, EFI EXT, EFI R, EFI Sno Pro	04-06	Arctic Cat Chart #12	Firecat Series - ZR4 Style Hood		
Firecat F7, Sno Pro, EFI, EFI EXT, EFI R, EFI Sno Pro	03-06	Arctic Cat Chart #12	Firecat Series - ZR4 Style Hood		
Four Stroke Trail, Touring	02-03	Arctic Cat Chart #11	ZR3 Style Hood		
Jag	75-77	761-1080	0116-688	13	Smoke
Jag 2000 F/A, 3000F/A	78-80	761-1170	0106-857	13	Smoke
Jag 2000 F/C, 3000F/C	81-81	761-1170	0117-203	13	Smoke
Jag Deluxe (leaf spring)	85-90	761-1220	0117-633	14 M	Smoke
Jag AFS, Deluxe	89-90	761-1300	0606-565	18 1/2 H	Smoke

**ARCTIC CAT WINDSHIELDS**

Model	Year	TCI PART #	OEM # / hood Style	H x W	Color
Jag 340	1990	761-1220	0117-633	14 M	Smoke
Jag Mountaincat	90-91	761-1221	0636-368	17 H	Smoke
Jag AFS	1991	Arctic Cat Chart #6	Lynx MC Style Hood		
Jag AFS L/T	91-93	Arctic Cat Chart #6	Lynx MC Style Hood		
Jag AFS-Special	91-95	Arctic Cat Chart #5	Jag Style Hood		
Jag AFS, LT	91-93	Arctic Cat Chart #6	Lynx MC Style Hood		
Jag Deluxe, Z	92-96	Arctic Cat Chart #5	Jag Style Hood		
Jag	95-96	Arctic Cat Chart #9	ZR1 Style Hood		
Jag Liquid	1996	Arctic Cat Chart #5	Jag Style Hood		
Jag, Jag Deluxe	97-99	761-1420 761-1430	0639-324 0639-323	14 1/2 x 28 L 21 1/2 x 31	Smoke Smoke
Jaguar Z1	07-08	Arctic Cat Chart #14	Original F Chassis		
King Cat 900, EFI Std.	04-06	Arctic Cat Chart #11	ZR3 Style Hood		
Lynx	71-73	761-1030	0106-191/0106-331	11	Clear
Lynx	1974	761-1040	0116-313	15 M	Smoke
Lynx, Deluxe	91-92	761-1300	0606-565	18 1/2 H	Smoke
Lynx	1993	Arctic Cat Chart #6	Lynx MC Style Hood		
Lynx MC	92-93	Arctic Cat Chart #6	Lynx MC Style Hood		
M Series (all)	12-16	Arctic Cat Chart #13	M-Series ZR4 Style Hood		
M5, M6, M7 EFI, M10	05-11	Arctic Cat Chart #13	M-Series ZR4 Style Hood		
Mountain Cat 500 EFI	01-04	Arctic Cat Chart #11	ZR3 Style Hood		
Mountain Cat 570	02-04	Arctic Cat Chart #11	ZR3 Style Hood		
Mountain Cat 600 EFI	01-04	Arctic Cat Chart #11	ZR3 Style Hood		
Mountain Cat 800, EFI	01-04	Arctic Cat Chart #11	ZR3 Style Hood		
Mountain Cat 900, EFI	03-04	Arctic Cat Chart #11	ZR3 Style Hood		
Mountain Cat 1000	01-02	Arctic Cat Chart #8	ZRT 2 Style Hood		
Pantera 440	1975	761-1050	0106-440	13	Smoke
Pantera	76-79	761-1130	0106-681	15	Smoke
Pantera F/C (Manual & Electric)	80-81	761-1200	0117-230	18	Smoke
Pantera	1985	761-1160	0106-937	13	Smoke
Pantera	86-89	761-1150 761-1151	0606-049 0606-043	15 M 21 H	Smoke Smoke
Pantera	1990	Arctic Cat Chart #6	Lynx MC Style Hood		
Pantera	91-94	Arctic Cat Chart #1	Pantera/Prowler Hood		
Pantera	95-98	Arctic Cat Chart #7	ZRT Style Hood		
Pantera 500 EFI	1999	Arctic Cat Chart #8	ZRT 2 Style Hood		
Pantera 580 EFI, 1000	00-01	Arctic Cat Chart #8	ZRT 2 Style Hood		
Pantera 550	02-05	Arctic Cat Chart #11	ZR3 Style Hood		
Pantera 600 EFI, ESR	02-06	Arctic Cat Chart #11	ZR3 Style Hood		
Pantera 800 EFI, ESR	02-04	Arctic Cat Chart #11	ZR3 Style Hood		
Panther	1970	761-1030	0106-191	11	Clear
Panther, 440 (Sachs), 634 (Hirth), JLO 650-760	1971	761-1010 761-1011	0106-247	11 Tall	Smoke
Panther 340, 299, 399m 440A-J, Axial Flow	1971	761-1010 761-1011	0106-247	11 Tall	Smoke
Panther	1972	761-1040	0116-313	15 M	Smoke
Panther P-295 Wankel, P-340, P-400, P-440	1973	761-1050	0106-440	13	Smoke
Panther 340	1974	761-1050	0106-440	13	Smoke
Panther VIP 440	1974	761-1050	0106-440	13	Smoke
Panther 440	74-75	761-1050	0106-440	13	Smoke
Panther	80-86	761-1200	0117-230	18	Smoke
Panther	1989	761-1241	0606-359	19	Smoke
Panther	1990	761-1300	0606-565	18 1/2 H	Smoke
Panther	1991	Arctic Cat Chart #6	Lynx MC Style Hood		
Panther	92-95	Arctic Cat Chart #5	Jag Style Hood		
Panther, Deluxe, L/C	96-97	Arctic Cat Chart #7	ZRT Style Hood		
Panther 550	1998	Arctic Cat Chart #7	ZRT Style Hood		
Panther 340, 440	98-00	761-1420 761-1430	0639-324 0639-323	Standard 21 1/2 x 31	Smoke Smoke
Panther 370, R	01/04/06-08	Arctic Cat Chart #11	ZR3 Style Hood		

## ARCTIC CAT WINDSHIELDS

Model	Year	TCI PART #	OEM # / hood Style	H x W	Color
Panther 440, ESR	01-02	Arctic Cat Chart #11	ZR3 Style Hood		
Panther 550	2001	Arctic Cat Chart #11	ZR3 Style Hood		
Panther 570, R, ESR	02-07	Arctic Cat Chart #11	ZR3 Style Hood		
Panther 600 Touring, Trail	2007	Arctic Cat Chart #11	ZR3 Style Hood		
Powder Extreme	97-98	Arctic Cat Chart #7	ZRT Style Hood		
Powder Special, EFI	95-97	Arctic Cat Chart #9	ZR1 Style Hood		
Powder Special, EFI, 500, 500 EFI, 600, 600 EFI, 700	98-00	Arctic Cat Chart #10	ZR2 Style Hood		
Prowler	1990	Arctic Cat Chart #1	Pantera/Prowler Hood		
Prowler, MC, 2-Up, Special	91-94	Arctic Cat Chart #1	Pantera/Prowler Hood		
Prowler, 2-Up	95-96	Arctic Cat Chart #7	ZRT Style Hood		
Puma	70-71	761-1010 761-1011	0106-247	11 Tall	Smoke
Puma	72-73	761-1040	0116-313	15 M	Smoke
Puma, Deluxe, 2-Up	94-96	Arctic Cat Chart #5	Jag Style Hood		
Puma, 2 UP, DLX	1997	761-1420 761-1430	0639-324 0639-323	Standard 21 1/2 x 31	Smoke Smoke
Sabercat 500, EFI, EFI LX, LX	04-06	Arctic Cat Chart #12	Firecat Series - ZR4 Style Hood		
Sabercat 600, EFI, EFI EXT, EFI LX, LX	04-06	Arctic Cat Chart #12	Firecat Series - ZR4 Style Hood		
Sabercat 700 EFI, EFI EXT, EFI LX	04-06	Arctic Cat Chart #12	Firecat Series - ZR4 Style Hood		
Sno Pro	2000	Arctic Cat Chart #11	ZR3 Style Hood		
Sno Pro	03-06	Arctic Cat Chart #12	Firecat Series - ZR4 Style Hood		
Super Jag	89-92	761-1241	0606-359	19	Smoke
Touring 4-Stroke / Trail 4-Stroke	02-03	Arctic Cat Chart #11	ZR3 Style Hood		
T660, Turbo ST, Turbo Touring WT	04-07	Arctic Cat Chart #4	Firecat 2 Style Hood		
Thunder Cat	93-95	Arctic Cat Chart #3	ThunderCat/Wildcat Style Hood		
Thunder Cat, MC	96-98	Arctic Cat Chart #7	ZRT Style Hood		
Thunder Cat 1000-MC	99-02	Arctic Cat Chart #8	ZRT 2 Style Hood		
Trail Cat	80-81	761-1190	0115-274	16	Smoke
Triple Touring 600	99-01	Arctic Cat Chart #8	ZRT 2 Style Hood		
TZ (except Turbo)	08-14	Arctic Cat Chart #14	Original F Chassis		
Wildcat 650, 750, EFI, MC (except '92 Std Wildcat)	88-92	Arctic Cat Chart #2	Wildcat Style Hood		
Wildcat 700 MC	1992	761-1340	0606-999		
Wildcat	93-94	Arctic Cat Chart #3	ThunderCat/Wildcat oe 0616-252		
Wildcat	95-96	Arctic Cat Chart #9	ZR1 Style Hood		
Z1 Models (except Turbo)	2009	Arctic Cat Chart #14	Original F Chassis		
Z 370	99-00	Arctic Cat Chart #10	ZR2 Style Hood		
Z 370, ES, 440-LX, 570-LX	01-07	Arctic Cat Chart #11	ZR3 Style Hood		
Z 440	95-97	Arctic Cat Chart #9	ZR1 Style Hood		
Z 440	98-00	Arctic Cat Chart #10	ZR2 Style Hood		
Z 440, ES	01-02	Arctic Cat Chart #11	ZR3 Style Hood		
Z 570, SS, ESR	02-04	Arctic Cat Chart #11	ZR3 Style Hood		
Z 570	06-07	Arctic Cat Chart #11	ZR3 Style Hood		
Z120	00-17	619-1050	Cobra Black w/green checks	7.5 Ultra Low	Black
ZL 440	1997	Arctic Cat Chart #9	ZR1 Style Hood		
ZL 440, 500, 600 EFI, Carb, 700	98-00	Arctic Cat Chart #10	ZR2 Style Hood		
ZL 500 ESR, EFI ESR	01-03	Arctic Cat Chart #11	ZR3 Style Hood		
ZL 550, ESR	01-03	Arctic Cat Chart #11	ZR3 Style Hood		
ZL 600 EFI, EFI ESR, EFI SS	01-03	Arctic Cat Chart #11	ZR3 Style Hood		
ZL 800 ESR, EFI ESR, EFI SS	01-03	Arctic Cat Chart #11	ZR3 Style Hood		
ZR 440, 580, 580 EFI, 700	94-97	Arctic Cat Chart #9	ZR1 Style Hood		
ZR 440	98-99	Arctic Cat Chart #11	ZR3 Style Hood		
ZR 500, 600, 600 EFI, 600 Carb, 700	98-99	Arctic Cat Chart #10	ZR2 Style Hood		
ZR 500, EFI / ZR 600, EFI	00-04	Arctic Cat Chart #11	ZR3 Style Hood		
ZR 700	2000	Arctic Cat Chart #11	ZR3 Style Hood		
ZR 800, EFI	01-04	Arctic Cat Chart #11	ZR3 Style Hood		
ZR 900, EFI Sno-Pro	03-06	Arctic Cat Chart #11	ZR3 Style Hood		
ZRT 600, 800	95-98	Arctic Cat Chart #7	ZRT Style Hood		
ZRT 600, 800	99-02	Arctic Cat Chart #8	ZRT 2 Style Hood		



**BRP SKI-DOO WINDSHIELDS**

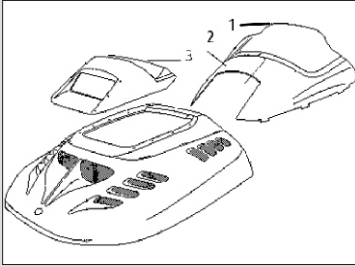

**F-2000** - Upper Insert only, mounted with nut and bolts. Fits onto the large one piece base. We do not carry the lower replacement base

**Bombardier Chart 1**

DESCRIPTION	OEM	TCI #
Low Black 5"	414-8554	761-3503
High Clear 12.5"	414-8554	761-3501
High Smoke 12.5"	414-8201	761-3502

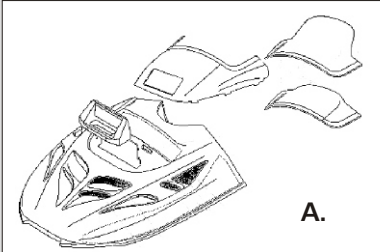

**A. S-2000** - Upper Insert only, mounted with nut and bolts. Fits onto large 1 pce base. We do not carry the lower replacement base. For complete replacement use Spotech Cobra Windshields.

DESCRIPTION	OEM	TCI #
Black 6"	414-8554	761-3503
Smoke 12.5"	414-8201	761-3502
Clear 17.5"	414-8554	761-3501

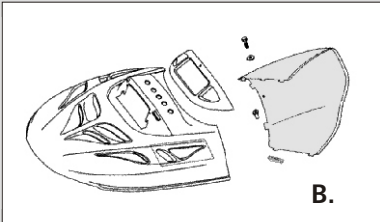

**B. S-2000** - Windshield with lamp molding around single/dual headlight

DESCRIPTION	OEM	TCI #
Low 13 x 27.5" Smoke	414-8873	761-3194
High 20 x 28.5" Clear	414-8872	761-3191

Windshield with tabs and nuts & Bolts.  
For complete replacement use Cobra Windshields.



619-3000

**Cobra S-2000 & Early MXZ** (Fits all S-Chassis including MXZ's)

DESCRIPTION	TCI #
Cobra Low 12.75" Black w/yellow flags	619-3001
Cobra Mid 15.5" Tint w/black flags	619-3000

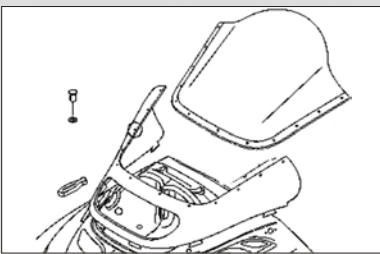

**CK-3**

**Bombardier Chart 3**

DESCRIPTION	OEM	TCI #
Smoke Mid 15"	415-0985-00	761-3540
Smoke - Medium 11"	415-0458-00	761-3463

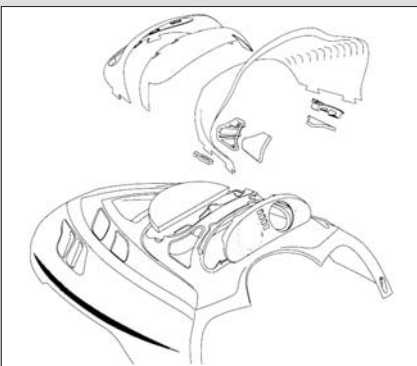

**ZX & ZX X Chassis**

**Bombardier Chart 4**

DESCRIPTION	OEM	TCI #
High 18" Clear	517-3023-56	761-3580
Mid 15" Smoke	517-3020-22	761-3582
Cobra Low 13.25" Black w/Yellow flags		619-3013



619-3013

**BRP SKI-DOO WINDSHIELDS**

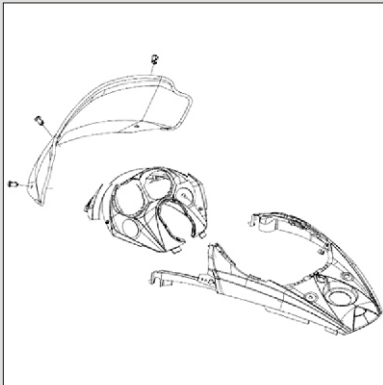

**RT Chassis '05-08**  
**Bombardier Chart 5**

**DESCRIPTION**  
 Cobra Low 14.5" Chrome  
 Cobra Mid 17" Tint

**TCI #**  
 619-3080  
 619-3081



619-3080



619-3081

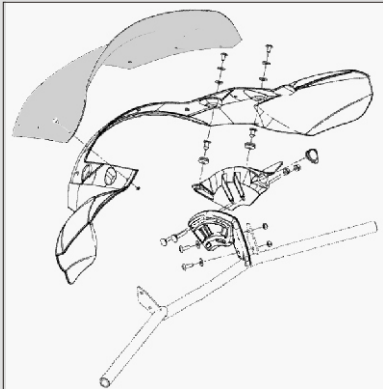

**Rev - Mobile** Handlebar mounted windshield for use with stock Fairing

**Bombardier Chart 6**

DESCRIPTION	OEM	TCI #
Low Smoke	517-3027-76	761-3602
Mid Smoke	517-3024-43	761-3600
High Clear	517-3028-14	761-3601
High Smoke	517-3028-14	761-3603

Cobra Mid 13.5" Clear w/Cobra logo 619-3044



619-3044

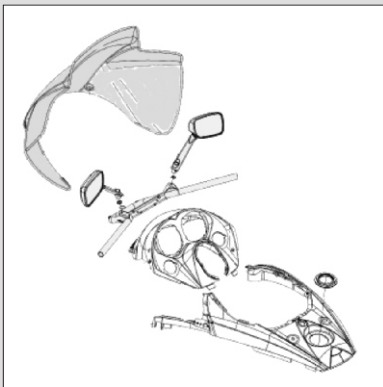

**Rev - Fixed**

Dash Mounted - Screen mounts to the cowling on the hood to operate without use of stock fairing.

**Bombardier Chart 7**

DESCRIPTION	OEM	TCI #
Low Smoke 11 1/2"	517-3035-65	761-3612
Low Black	517-3035-65	761-3614
Mid Smoke 18 1/4"	517-3035-11	761-3611
High Smoke 20 1/4"	517-3035-09	761-3613

Cobra Mid Matt Black w/logo 3 bolt style 619-13030  
 Cobra 11" Mid Chrome 4 bolt style 619-3045



619-3045



**BRP SKI-DOO WINDSHIELDS**

**Rev XP (2008-16)**

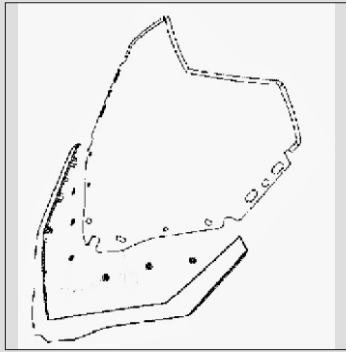

**Bombardier Chart 8**

DESCRIPTION	TCI #
Mid Smoke 15"	761-3650
Cobra Low Black 12"	619-3055
Cobra Mid Tint w/Black graphics 15"	619-3091
Cobra Tall Clear w/Black graphics 17.25"	619-3056
Cobra ExtraTall Clear w/Black graphics 20"	619-3057



619-3091

**Rev XM & XS (2013-19)**

(Does Not Fit Rev XP, XR or XU Chassis) Base Not Included

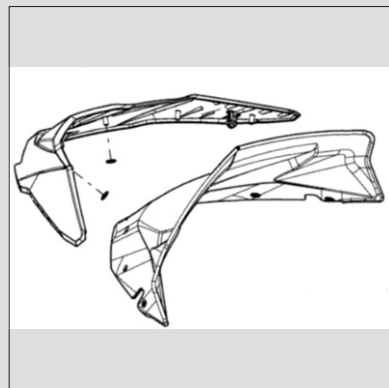

**Bombardier Chart 9**

DESCRIPTION	TCI #
Cobra Low Tint 14"	619-3005
Cobra Mid Clear w/Black Graphics 17"	619-3006
Cobra High Clear w/Black Graphics 19"	619-3007



619-3005

**Gen 4 Chassis (2018-2021)**

**Bombardier Chart 10**

Cobra Low Tint 14"	619-3025
Cobra Mid Clear w/Black Fade 20"	619-3025
Cobra High Clear w/Black Fade 22"	619-3027



619-3026

## WINDSHIELD APPLICATIONS - BRP (MOTO-SKI)

Model	Years	PART #	OEM #	Notes	H x W	Color
Futura 400, 400 E	77-78	761-3230	414-247-200		13	Smoke
Futura 440, 440 E	76-78	761-3230	414-247-200		13	Smoke
Futura 444 LC	1978	761-3230	414-247-200		13	Smoke
Grand Prix MX	81	761-9131	414-437-900		Standard	Smoke
Mirage I, II, IIE, Special	80-83	761-3411	414-483-300		13 L	Smoke
		761-3171			21 H	Clear
Nuvik	79	761-9140	414-345-600		Standard	Clear
Super Ultra	81-82	761-9131	414-437-900		Standard	Smoke
Ultra Sonic	82	761-9192	414-474-000		Standard	Clear

## WINDSHIELD APPLICATIONS - BRP (SKI-DOO)

Model	Years	PART #	OEM #	Notes	H x W	Color
Gen4 Chassis	18-21	Bombardier Chart # 10				
Rev Chassis	03-07	Bombardier Chart # 6 & 7				
Rev XM & XS Chassis	14-19	Bombardier Chart # 9				
Rev XP Chassis	08-16	Bombardier Chart # 8				
S-2000 Chassis & Early MX-Z Chassis		Bombardier Chart # 2				
ZX 7 ZX X Chassis		Bombardier Chart # 4				
Alpine 370, 370E, 399, 640E	69-70	761-3160	414-0483-00		13	Clear
Alpine	76-87	761-3310	414-5412-00		17	Smoke
		761-3311	414-4439-00		16 1/4	Clear
Alpine	88-95	761-3250	414-6098-00		24	Clear
Blizzard	71	761-3040	414.0638			
Blizzard 5500, 7500, 9500	79-80	761-3360	414.3822			
Blizzard, MX	81-84	761-3450	414-4835-00		15	Smoke
Cheyenne	89-91	761-3140	414-5927-00		16 1/4 L	Smoke
Citation	80-84	761-3411	414-483-300		13 L	Smoke
		761-3171			18 H	Clear
Citation LS, LSE, LSX	85-91	761-3420	414-6226-00		18 M	Clear
Elan 250, 294, 300SS	72-79	761-3050	414-1223-00		15	Smoke
Elan	80-90	761-3281	414-5575-00		14 1/2	Smoke
Elan	91-96	761-3290	580-5456-00		14 1/4	Clear
Everest 340	74-77	761-3100	414-1942-00	w/2 tabs	14 3/4	Smoke
Everest 340	78-79	761-3230	414-2472-00		13	Smoke
Everest 440	76-79	761-3230	414-2472-00		13	Smoke
Everest 467	80-83					
Everest 500	80-83	761-3330	414-2472-00		13	Smoke
Expedition 550 Sport RER	05-06	Bombardier Chart # 6	Rev Chassis (handlebar mounted)			
Expedition TUV 600, 800, V-1300	05-09	Bombardier Chart # 4	ZX & ZX X Chassis Style			
Expedition V-1000 TUV	05-06	Bombardier Chart # 4	ZX & ZX X Chassis Style			
Formula 500, Deluxe, 583	97-98	Bombardier Chart # 2	S-2000 Series Chassis Style			
Formula 500 LC	2000	Bombardier Chart # 2	S-2000 Series Chassis Style			
Formula 583, 670	98-99	Bombardier Chart # 2	S-2000 Series Chassis Style			
Formula Deluxe 380	1999	Bombardier Chart # 2	S-2000 Series Chassis Style			
Formula Deluxe 380, 500 (Fan)	00-01	Bombardier Chart # 2	S-2000 Series Chassis Style			
Formula Deluxe 500	97-99	Bombardier Chart # 2	S-2000 Series Chassis Style			
Formula Deluxe 500 L/C	2000	Bombardier Chart # 2	S-2000 Series Chassis Style			
Formula Deluxe 500	2001	Bombardier Chart # 4	ZX & ZX X Chassis Style			
Formula Deluxe Fan	2001	Bombardier Chart # 2	S-2000 Series Chassis Style			
Formula Deluxe 583, 670	1999	Bombardier Chart # 2	S-2000 Series Chassis Style			
Formula Deluxe 600, 700	00-01	Bombardier Chart # 4	ZX & ZX X Chassis Style			
Formula EFI	1994	761-3372	580-5759-00		12 1/2	Black
		761-3380	414-7707-00		12 M	Smoke
		761-3370	414-7642-000		14 H	Clear
Formula Grand Touring	93-94	761-3372	580-5759-00		12 1/2	Black
		761-3380	414-7707-00		12 M	Smoke
		761-3370	414-7642-000		14 H	Clear
Formula III, LT	96-97	Bombardier Chart # 1	F-2000 Series Chassis Style			
Formula III 600, LT	98-99	Bombardier Chart # 3	CK3 Chassis Style			
Formula III 700	98-00	Bombardier Chart # 3	CK3 Chassis Style			
Formula LT	95-96	Bombardier Chart # 1	F-2000 Series Chassis Style			
Formula Mach I, XTC	85-90	761-3349	414-5608-00		13 3/4	Black
		761-3341	414-6444-00		18 H	Clear
Formula Mach I, XTC, R	91-94	761-3372	580-5759-00		12 1/2	Black
		761-3380	414-7707-00		12 M	Smoke
		761-3370	414-7642-000		14 H	Clear
Formula Mach I	95-97	Bombardier Chart # 1	F-2000 Series Chassis Style			
Formula Mach Z	93-97	Bombardier Chart # 1	F-2000 Series Chassis Style			

**WINDSHIELD APPLICATIONS - BRP (SKI-DOO)**

Model	Years	PART #	OEM #	Notes	H x W	Color
Formula MX, MX-LT	85-90	761-3349 761-3341	414-5608-00 414-6444-00		13 3/4 18 H	Black Clear
Formula MX, XTC, R, II	91-93	761-3372 761-3380 761-3370	580-5759-00 414-7707-00 414-7642-000		12 1/2 12 M 14 H	Black Smoke Clear
Formula MX Z	93-95	Bombardier Chart #1	F-2000 Series Chassis Style			
Formula MX	94-96	Bombardier Chart #1	F-2000 Series Chassis Style			
Formula Plus	85-90	761-3349 761-3341	414-5608-00 414-6444-00		13 3/4 18 H	Black Clear
Formula Plus, XTC	91-94	761-3372 761-3380 761-3370	580-5759-00 414-7707-00 414-7642-000		12 1/2 12 M 14 H	Black Smoke Clear
Formula S, SLS	95-98	Bombardier Chart #2	S-2000 Series Chassis Style			
Formula S	2000	Bombardier Chart #2	S-2000 Series Chassis Style			
Formula SL	96-99	Bombardier Chart #2	S-2000 Series Chassis Style			
Formula SS	95-96	Bombardier Chart #1	F-2000 Series Chassis Style			
Formula ST, STX, STX II	94-96	Bombardier Chart #1	F-2000 Series Chassis Style			
Formula XTC, SE	1994	761-3372 761-3380 761-3370	580-5759-00 414-7707-00 414-7642-000		12 1/2 12 M 14 H	Black Smoke Clear
Formula Z	94-96	Bombardier Chart #1	F-2000 Series Chassis Style			
Formula Z	1997	Bombardier Chart #2	S-2000 Series Chassis Style			
Formula Z 500	1999	Bombardier Chart #2	S-2000 Series Chassis Style			
Formula Z 600, 700	2000	Bombardier Chart #4	ZX & ZX X Chassis Style			
Grand Lux	85-86	761-3140	414-5184-00		16 1/4 L	Smoke
Grand Touring 380 Fan	2002	Bombardier Chart #4	ZX & ZX X Chassis Style			
Grand Touring 470, 580, 670, SE	95-96	Bombardier Chart #1	F-2000 Series Chassis Style			
Grand Touring 500	2001	Bombardier Chart #4	ZX & ZX X Chassis Style			
Grand Touring 500	96-97	Bombardier Chart #2	S-2000 Series Chassis Style			
Grand Touring 500 Fan, Sport	02-03	Bombardier Chart #4	ZX & ZX X Chassis Style			
Grand Touring 500, 580, SE	1996	Bombardier Chart #2	S-2000 Series Chassis Style			
Grand Touring 600, GS, SE, Sport	00-03	Bombardier Chart #4	ZX & ZX X Chassis Style			
Grand Touring 700, GS, Sport	01-03	Bombardier Chart #4	ZX & ZX X Chassis Style			
Grand Touring 800 SE	02-03	Bombardier Chart #4	ZX & ZX X Chassis Style			
Grand Touring 800 SE	2001	Bombardier Chart #3	CK3 Chassis Style			
Grand Touring SE	98-00	Bombardier Chart #3	CK3 Chassis Style			
Grand Touring SE, 700	98-00	Bombardier Chart #3	CK3 Chassis Style			
Grand Touring Sport 550 / 600 / ACE	12-18	Bombardier Chart #8	Rev XP Chassis			
GSX 380, 550 Fan RER	05-06	Bombardier Chart #6	Rev Chassis (handlebar mounted)			
GSX Fan 550F	2009	Bombardier Chart #7	Rev Chassis (fixed mounted)			
GSX LE 800HO, E-Tec	10-13	Bombardier Chart #8	Rev XP Chassis			
GSX Limited 600/800	04-05	Bombardier Chart #6	Rev Chassis (handlebar mounted)			
GSX LTD, Sport 600HO SDI	2008	Bombardier Chart #8	Rev XP Chassis			
GSX LTD, Touring 600 HO SDI	08-09	Bombardier Chart #8	Rev XP Chassis			
GSX SE 800R, E-Tec	08,12	Bombardier Chart #8	Rev XP Chassis			
GSX Sport 500 SS RER	05-06	Bombardier Chart #6	Rev Chassis (handlebar mounted)			
GSX Sport 550F / 600	2010	Bombardier Chart #8	Rev XP Chassis			
GSX Sport 600/800	04-05	Bombardier Chart #6	Rev Chassis (handlebar mounted)			
GSX Sport LTD, Fan	04-05	Bombardier Chart #6	Rev Chassis (handlebar mounted)			
GSX Sport, 500SS, 380, 550F, LTD	06-07	Bombardier Chart #7	Rev Chassis (fixed mounted)			
GSX Sport, LTD 600-800 H.O.	06-07	Bombardier Chart #7	Rev Chassis (fixed mounted)			
Legend 380 Fan, 500 Fan, Sport	02-04	Bombardier Chart #4	ZX & ZX X Chassis Style			
Legend 600SE, 600 Sport, GS600	02-04	Bombardier Chart #4	ZX & ZX X Chassis Style			
Legend 700 Sport, GS700	02-04	Bombardier Chart #4	ZX & ZX X Chassis Style			
Legend 800 SE	02-04	Bombardier Chart #4	ZX & ZX X Chassis Style			
Legend Sport 1000	02-05	Bombardier Chart #4	ZX & ZX X Chassis Style			
Mach I, Z, ZLT	98-03	Bombardier Chart #3	CK3 Chassis Style			
Mach Z 1000 SDI	05-08	Bombardier Chart #5	RT Chassis Style			
MX Z	1997	Bombardier Chart #2	S-2000 Series Chassis Style			
MX Z 380 Fan	2006	Bombardier Chart #6	Rev Chassis (handlebar mounted)			
MX Z 380 Fan, MXZ 500 Fan	2001	Bombardier Chart #2	S-2000 Series Chassis Style			
MX Z 380, 500SS Trail, 550F	06-07	Bombardier Chart #7	Rev Chassis (fixed mounted)			
MX Z 440, MXZ 440F, MXZ 440 Fan	96-01	Bombardier Chart #2	S-2000 Series Chassis Style			
MX Z 500	00-01	Bombardier Chart #4	ZX & ZX X Chassis Style			
MX Z 500	97-99	Bombardier Chart #2	S-2000 Series Chassis Style			
MX Z 500 Fan, 500 RER Sport, Trail	02-03	Bombardier Chart #4	ZX & ZX X Chassis Style			
MX Z 500, 600 Trail	04-05	Bombardier Chart #6	Rev Chassis (handlebar mounted)			
MX Z 500, 600, 800 Adrenaline	04-05	Bombardier Chart #6	Rev Chassis (handlebar mounted)			

## WINDSHIELD APPLICATIONS - BRP (SKI-DOO)

Model	Years	PART #	OEM #	Notes	H x W	Color
MX Z 500, 600, 800 Adrenaline X	05-08	Bombardier Chart #5	RT Chassis Style			
MX Z 550 X	06-09	Bombardier Chart #7	Rev Chassis (fixed mounted)			
MX Z 550 X Fan	06-08	Bombardier Chart #6	Rev Chassis (handlebar mounted)			
MX Z 583	97-98	Bombardier Chart #2	S-2000 Series Chassis Style			
MX Z 600 (all except REV)	99-03	Bombardier Chart #4	ZX & ZX X Chassis Style			
MX Z 600 REV H.O.	04-05	Bombardier Chart #6	Rev Chassis (handlebar mounted)			
MX Z 600 Sport REV H.O.	2003	Bombardier Chart #7	Rev Chassis (fixed mounted)			
MX Z 600, 800 Renegade/X	04-05	Bombardier Chart #6	Rev Chassis (handlebar mounted)			
MX Z 600, 800 X H.O. DPM RER	04-05	Bombardier Chart #6	Rev Chassis (handlebar mounted)			
MX Z 600, 800HO-SDI	04-07	Bombardier Chart #7	Rev Chassis (fixed mounted)			
MX Z 670, H.O.	97-99	Bombardier Chart #2	S-2000 Series Chassis Style			
MX Z 700 (all except REV)	00-03	Bombardier Chart #4	ZX & ZX X Chassis Style			
MX Z 800 (all except REV)	01-03	Bombardier Chart #4	ZX & ZX X Chassis Style			
MX Z Adrenaline, Renegade	04-07	Bombardier Chart #7	Rev Chassis (fixed mounted)			
MX Z Blizzard 600HO, SDI	2007	Bombardier Chart #7	Rev Chassis (fixed mounted)			
MX Z Fan	02-04	Bombardier Chart #4	ZX & ZX X Chassis Style			
MX Z Rev 600 X H.O.	03-05	Bombardier Chart #7	Rev Chassis (fixed mounted)			
MX Z Rev models	03-07	Bombardier Chart #7	Rev Chassis (fixed mounted)			
MXZ 550 TNT 550F	10-14	Bombardier Chart #8	Rev XP Chassis			
MXZ 550 TNT 600 (all)	09-13	Bombardier Chart #8	Rev XP Chassis			
MXZ 800R, X, X-RS	08-13	Bombardier Chart #8	Rev XP Chassis			
MXZ Adrenaline 600, 800R	08-10	Bombardier Chart #8	Rev XP Chassis			
MXZ Renegade	08-09	Bombardier Chart #8	Rev XP Chassis			
MXZ Sport 550F / 600 (2 stroke)	10-18	Bombardier Chart #8	Rev XP Chassis			
MXZ TNT 500SS	2009	Bombardier Chart #8	Rev XP Chassis			
MX ZX 440 Race	04-05	Bombardier Chart #6	Rev Chassis (handlebar mounted)			
MX ZX, 600RS, SDI, E-Tec	09-13	Bombardier Chart #8	Rev XP Chassis			
MX Z X - XRS	06-07	Bombardier Chart #7	Rev Chassis (fixed mounted)			
Nordic	69-71	761-3160			13	Clear
Nordik	81-83	761-3411 761-3171	414-483-300		13 L 18 H	Smoke Clear
Nordik	87-91	761-3190	414-625-400		18	Smoke
Olympique	69-70	761-3010	414-018-700		13 1/2	Smoke
Olympique	72-74	761-3060	414-128-400		14	Clear
Olympique	75-79	761-3130	414-215-700		16 3/4 H	Clear
Renegade / Backcountry 600 / 800	10-13	Bombardier Chart #8	Rev XP Chassis			
Renegade Sport 550F / 600 (2 stroke)	11-18	Bombardier Chart #8	Rev XP Chassis			
Renegade X / Adrenaline 600/800	10-13	Bombardier Chart #8	Rev XP Chassis			
Rev Chassis (all with mobile mount)	04-09	Bombardier Chart #6	Rev Chassis (handlebar mounted)			
Rev Chassis (all with fixed mount)	04-09	Bombardier Chart #7	Rev Chassis (fixed mounted)			
Safari 377, 447, GL LC 532	84-89	761-3140	414-592-700		16 1/4 L	Smoke
Safari Stratos	1987	761-3220	414-644-200		12 1/2	Clear
Safari Escapade	87-89	761-3220	414-644-200		12 1/2	Clear
Safari Cheyenne, 503-R	88-91	761-3140	414-592-700		16 1/4 L	Smoke
Safari Voyager	1989	761-3220	414-644-200		12 1/2	Clear
Safari Grand Lux	89-91	761-3140	414-592-700		16 1/4 L	Smoke
Safari Scout-E, Saga	89-92	761-3140	414-592-700		16 1/4 L	Smoke
Safari L, LC, LCE, LE, LX-E, GLX	90-94	761-3240 761-3242	580-554-800 414-775-800	11 Tabs 11 Tabs	17 1/2 L 22 H	Clear Clear
Safari DLX, Rally, Std	93-94	761-3243 761-3242 761-3244	414-831-500 414-775-800	8 Tabs 11 Tabs 11 Tabs	17 1/2 22 H 27 H	Clear Clear Smoke
Skandic 335, 355	70-71	761-3160			13	Clear
Skandic 277, 377, 503	82-87	761-3411 761-3171	414-483-300		13 L 18 H	Smoke Clear
Skandic 440	01-02	TBA	M5340168			
Skandic 503, 377 R, Std	1987	761-3140	414-592-700		16 1/4 L	Smoke
Skandic II-R, 503 R-SLT	92-94	761-3240 761-3242	580-554-800 414-775-800	11Tabs 11Tabs	17 1/2 L 22 H	Clear Clear
Skandic 380, 500	95-00	Bombardier Chart #2	S-2000 Series Chassis Style			
Skandic Widetrack	95	Bombardier Chart #2	S-2000 Series Chassis Style			
Skandic WT, SWT	96-02	TBA	M5340168			
Skandic WT LC	98-99	Bombardier Chart #2	S-2000 Series Chassis Style			
Skandic 500	01-03	Bombardier Chart #2	S-2000 Series Chassis Style			
Skandic 600 WT	2002	Bombardier Chart #2	S-2000 Series Chassis Style			
Skandic 600	2003	761-3590	M5147892		18 H	Clear
Skandic Sport LC, LT, WT, SWT	03-04	Bombardier Chart #4	ZX & ZX X Chassis Style			
Skandic 440F LT, SWT 500-550F	03-07	761-3590	M5147892		18 H	Clear

**WINDSHIELD APPLICATIONS - BRP (SKI-DOO)**

Model	Years	PART #	OEM #	Notes	H x W	Color
Skandic WT-SWT 500F-550F-600	03-07	761-3590	M5147892		18 H	Clear
Skandic SUV 550F-600	04-07	761-3590	M5147892		18 H	Clear
Skandic SWT V-800, Yeti II	07-12	Bombardier Chart #4	ZX & ZX X Chassis Style			
Skandic (all)	08-09	Bombardier Chart #4	ZX & ZX X Chassis Style			
Skandic 550F, SUV, SWT	08-10	Bombardier Chart #4	ZX & ZX X Chassis Style			
Skandic WT 600	08-10	Bombardier Chart #4	ZX & ZX X Chassis Style			
Skandic WT 550F, Yeti II	08-11	Bombardier Chart #4	ZX & ZX X Chassis Style			
Summit 470, 583, 670	94-97	Bombardier Chart #1	F-2000 Series Chassis Style			
Summit 500	97-00	Bombardier Chart #2	S-2000 Series Chassis Style			
Summit 500 Fan	02-03	Bombardier Chart #4	ZX & ZX X Chassis Style			
Summit 500, 583, 670	1996	Bombardier Chart #2	S-2000 Series Chassis Style			
Summit 50th Anniversary	2009	Bombardier Chart #8	Rev XP Chassis			
Summit 550F, 600	08-09	Bombardier Chart #7	Rev Chassis (fixed mounted)			
Summit 583	97-98	Bombardier Chart #2	S-2000 Series Chassis Style			
Summit 600, 700 (all)	99-03	Bombardier Chart #4	ZX & ZX X Chassis Style			
Summit 600, 800 Adrenaline	04-05	Bombardier Chart #6	Rev Chassis (handlebar mounted)			
Summit 600, 800 X	04-05	Bombardier Chart #6	Rev Chassis (handlebar mounted)			
Summit 670	97-98	Bombardier Chart #2	S-2000 Series Chassis Style			
Summit 800 Highmark Xtreme	2004	Bombardier Chart #6	Rev Chassis (handlebar mounted)			
Summit 800 Highmark, X	2004	Bombardier Chart #6	Rev Chassis (handlebar mounted)			
Summit 800 Sport	2004	Bombardier Chart #6	Rev Chassis (handlebar mounted)			
Summit 800, Highmark (all)	01-03	Bombardier Chart #4	ZX & ZX X Chassis Style			
Summit Adrenaline 600 HO SDI	2008	Bombardier Chart #8	Rev XP Chassis			
Summit Everest 500SS / 600 HO / R	09-11	Bombardier Chart #8	Rev XP Chassis			
Summit Fan	2001	Bombardier Chart #2	S-2000 Series Chassis Style			
Summit Fan	2004	Bombardier Chart #4	ZX & ZX X Chassis Style			
Summit Freeride 800R E-Tec	11-13	Bombardier Chart #8	Rev XP Chassis			
Summit Highmark	05-08	Bombardier Chart #5	RT Chassis Style			
Summit Hillclimb	09-11	Bombardier Chart #8	Rev XP Chassis			
Summit Sport 600 / 800	10-18	Bombardier Chart #8	Rev XP Chassis			
Summit X 600HO / 800R	09-12	Bombardier Chart #8	Rev XP Chassis			
Summit X 670	1999	Bombardier Chart #2	S-2000 Series Chassis Style			
Summit X, XRS	06-07	Bombardier Chart #7	Rev Chassis (fixed mounted)			
TNT F/C 300, 340, 440	74-76	761-3100	414-194-200		14 1/2	Smoke
TNT Everest	1976	761-3230	414-247-200		13	Smoke
TNT F/A	1977	761-3230	414-247-200		13	Smoke
TNT F/C	77-78	761-3390	414-274-900		12	Smoke
TNT F/A	1978	761-3390	414-274-900		12	Smoke
Touring 500 LC	2000	Bombardier Chart #2	S-2000 Series Chassis Style			
Touring E, LE, SLE	95-01	Bombardier Chart #2	S-2000 Series Chassis Style			
Touring ELT, L	95-99	Bombardier Chart #2	S-2000 Series Chassis Style			
Tundra (all)	85-05	761-3420	414-829-400/414-622-600		18 M	Clear
X 1000 SDI Renegade	05-08	Bombardier Chart #5	RT Chassis Style			

**WINDSHIELD APPLICATIONS - JOHN DEERE**

JOHN DEERE MODEL	Years	TCI PART #	OEM #	Notes	H x W	Color
300	74-77	761-7050	AM52321		16 1/2	Clear
400	72-77	761-7050	AM52321		16 1/2	Clear
500	72-74	761-7050	AM52321		16 1/2	Clear
600	73-75	761-7050	AM52321		16 1/2	Clear
800	1975	761-7050	AM52321		16 1/2	Clear
Cyclone 340 / 440	76-78	761-7030	AM53817		16 1/2	Clear
JDX295/s	74	761-7020	AM52426		9 1/2	Clear
JDX4	73-75	761-7050	AM52426		16 1/2	Clear
JDX4 Special	1974	761-7050	AM52426		16 1/2	Clear
JDX 6	74-75	761-7050	AM52426		16 1/2	Clear
JDX 8	73-75	761-7050	AM52426		16 1/2	Clear
Liquidator 340	1976	761-7030	AM53817		16 1/2	Clear
Liquifire 340 / 440	76-78	761-7030	AM53817		16 1/2	Clear
Liquifire Cross Country	80-84	761-7080	AM55084	7 Tabs	18 1/2	Clear
Liquifire Sport	80-84	761-7060	AM55050	6 Tabs	16	Clear
Snowfire	82-84	761-7090	AM55666		14 3/4	Clear
Spitfire	78-82	761-7040	AM54339		14 3/4	Clear
Sportfire 440 Cross Country	80-84	761-7080	AM55084	7 Tabs	18 1/2	Clear
Sprintfire	83-84	761-7090	AM55666		14 3/4	Clear
Trailfire Cross Country 340 / 440	79-83	761-7080	AM55084	7 Tabs	18 1/2	Clear
Trailfire Special Canada 440	81/83	761-7080	AM55084	7 Tabs	18 1/2	Clear
Trailfire Trail 340 / 440	79-84	761-7060	AM55050	6 Tabs	16	Clear
Trailfire Special Canada 440	1982	761-7060	AM55050	6 Tabs	16	Clear
KAWASAKI MODEL	Years	TCI PART #	OEM #	Notes	H x W	Color
Drifter F/A 340	80	761-5202	39154-3511		Standard	Smoke



761-7020



761-7030



761-7040



761-7050



761-7060



761-7080



761-7090



761-5202

**WINDSHIELD APPLICATIONS SCORPION**

800 RMK Khaos	2020	Polaris Chart #9		Axys Chassis		
800 RMK R/ Pro	12-15	Polaris Chart #8		Pro Ride Chassis		
800 RMK Shift	2009	Polaris Chart #7		IQ Chassis		
800 RMK Vertical Escape	2003	Polaris Chart #6	2872910	Edge Chassis		
800 Rush (all)	11-13	Polaris Chart #8		Pro Ride Chassis		



761-8080



761-8100



## POLARIS WINDSHIELDS

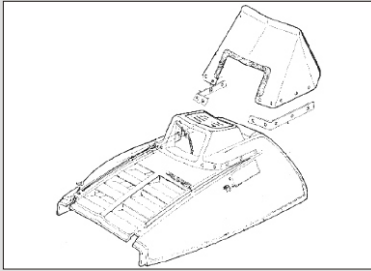

### Old Style Hood (rough years 1981- 87)

#### Polaris Chart 1

DESCRIPTION	TCI #
Standard 17" Smoke	761-2141
Low 10.5" Smoke	761-2143
MH 13" Smoke	761-2147

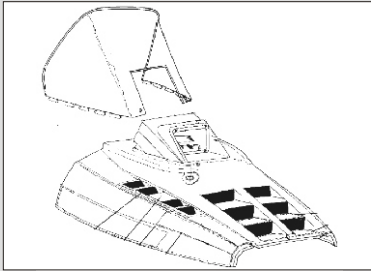

### Original or Wedge Hood Style (1988-1998)

#### Polaris Chart 2

DESCRIPTION	OEM	TCI #
Low 10" Black	2870785	761-2179
Std. 15 1/2" Smoke	5431144	761-2170
High 21" Clear	5431118	761-2172

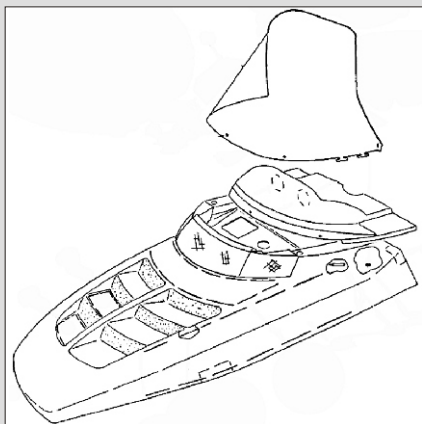

### Evolved Chassis (1993-1999)

#### Polaris Chart 3

DESCRIPTION	OEM	TCI #
Low 9.5" Red		761-2283
Std. 19" Smoke	5431653	761-2281
Plum Screen Full Flared		761-2982
Red Screen Full Flared		761-2983
Purple Screen Full Flared		761-2984
Blue Screen Full Flared		761-2985



761-2281



761-2984

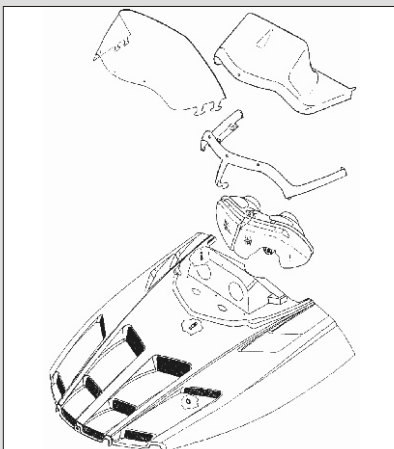

### Aggressive Chassis (1996-1999)

#### Polaris Chart 4

DESCRIPTION	OEM	TCI #
Low 12.5" Clear	2871402	761-2301
Low 12.5" Smoke	2871403	761-2302
MW 15" Smoke	2871612	761-2304
High 17 x 29" Smoke	2871709	761-2303
Cobra Mid Tint w/black fade 13.5"		619-2040
Cobra High Tint w/black fade 16"		619-2041



## POLARIS WINDSHIELDS

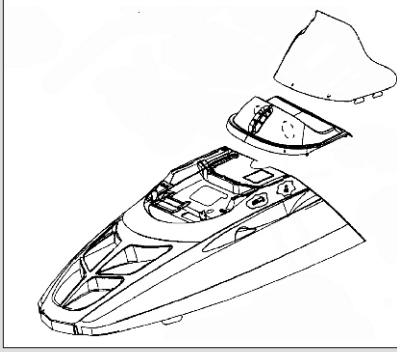

### Generation II Chassis (1999-2004) Polaris Chart 5

DESCRIPTION	OEM	TCI #
Mid Height 15 x 31" Smoke	2872530	761-2314
High Flared Tint w/graphics 17"	2872561	761-21403
Cobra Low Black w/flag graphics 10"		619-2011
Cobra Mid Smoke w/flag graphics 15"		619-2017

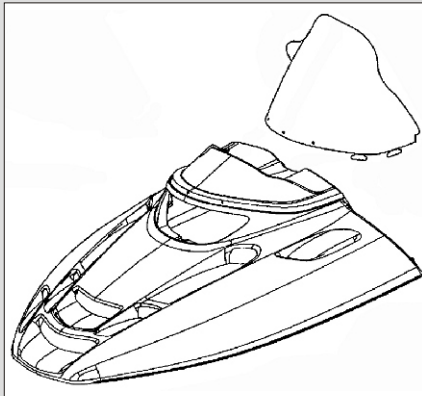

### Edge Chassis (1999-2010) Polaris Chart 6

DESCRIPTION	OEM	TCI #
Cobra Extreme Low Yellow w/logo 9"		619-2062
Cobra Low Red Chrome 11"		619-2018
Cobra Low Clr w/blk accent & red/yellow flames 11"		619-2063
Cobra Low Clear w/red & yellow graphics 11"		619-2022
Low Smoke 12.5"	2872911	761-2290
Mid Smoke 15"	2872562	761-2291
Cobra Mid Tint w/Black accents 13"		619-2023
High Clear 17.5"	2872910	761-2292



619-2062



619-2018



619-2063

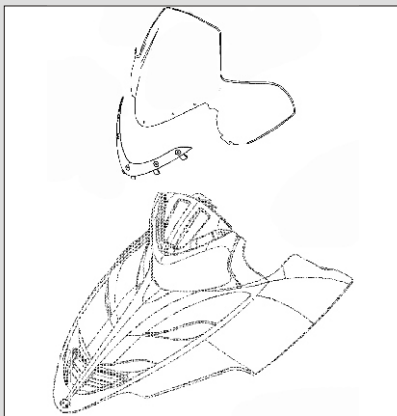

### IQ & IQ RMK Chassis (2005-2015)

(Fits IQ Chassis from 2007-2015 & 2005-2011 RMK & Switchback)

#### Polaris Chart 7

DESCRIPTION	OEM	TCI #
High Smoke 19"	5436242	761-2344
High Clear 19"	5436242	761-2345
Cobra Low Solid Black 11.5"		619-2035
Cobra Mid Clr w/ Black graphics 13"		619-2036
Cobra Tall Clr w/ Black graphics 13"		619-2037



619-2035



619-2037

## POLARIS WINDSHIELDS

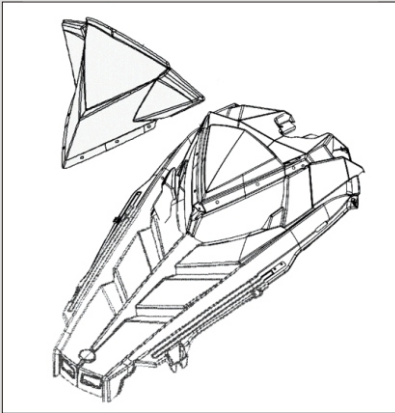

### Pro Ride Chassis (2010-14)

#### Polaris Chart 8

DESCRIPTION	OEM	TCI #
Low Black 4"	5437511	761-2400
Mid Smoke - 12"	2877841	761-2401
Mid Clear - 12"	5438871	761-2402
Cobra Low Tint 15"		619-2045
Cobra Mid Clr w/black fade - 19"		619-2046
Cobra Mid Clr w/black fade - 20.5"		619-2047

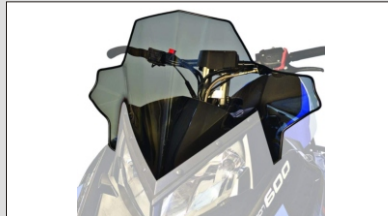

619-2045



619-2047

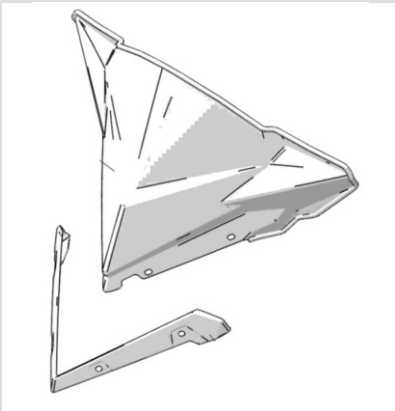

### Axyx Chassis (2015 +)

#### Polaris Chart 9

DESCRIPTION	TCI #
Cobra Low Tint 16"	619-2055
Cobra Mid Clr w/black graphics - 18.5"	619-2056
Cobra Tall Clr w/black graphics - 20.5"	619-2057



619-2055



619-2057

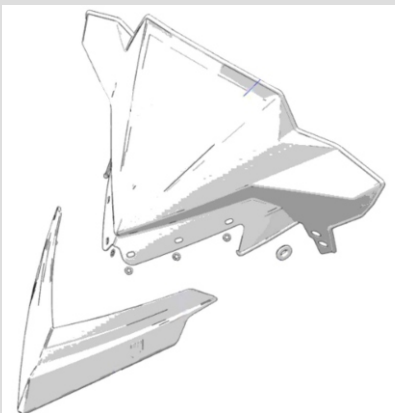

### Matryx Chassis (2021 +)

#### Polaris Chart 10

DESCRIPTION	TCI #
Cobra Mid Clr w/black graphics - 18"	619-2070
Cobra Tall Clr w/black graphics - 20"	619-2071



619-2070



619-2071

## WINDSHIELD APPLICATIONS - POLARIS

Model	Year	TCI PART #	OEM #	Notes	H x W	Color
340 Classic	05-06	Polaris Chart #6	2872910	Edge Chassis		
340 Edge / Edge Classic	2003	Polaris Chart #6	2872910	Edge Chassis		
340 Edge LX / Edge Touring	2007	Polaris Chart #6	2872910	Edge Chassis		
340 Indy, Deluxe	99-02	Polaris Chart #5		Gen II Chassis		
340 Indy / INT'L / Classic	2004	Polaris Chart #6	2872910	Edge Chassis		
340 Indy Touring	99-03	761-2327 761-2328	5432842 2871419/5432671		17 19	Clear Smoke
340 Touring	04-06	Polaris Chart #6	2872910	Edge Chassis		
340 Transport	2008	Polaris Chart #6	2872910	Edge Chassis		
500	1998	Polaris Chart #3		Evolved Chassis		
500	2000	Polaris Chart #5		Gen II Chassis		
500	01-02/05-06	Polaris Chart #6	2872910	Edge Chassis		
400 Indy	94-97	Polaris Chart #3		Evolved Chassis		
400 Indy, SKS	88-92	Polaris Chart #2		Wedge or Original		
400 SKS	1987	Polaris Chart #1		Old Style Hood		
400, Indy	83-87	Polaris Chart #1		Old Style Hood		
440 Indy	1998	Polaris Chart #3		Evolved Chassis		
440 IQ	05-06	619-2038			12"	Black
440 IQ	2007	Polaris Chart #7		IQ Chassis		
440 L/C	95-97	Polaris Chart #3		Evolved Chassis		
440 Pro X	01-03	Polaris Chart #6	2872910	Edge Chassis		
440 Pro X Fan Cooled	02-03	Polaris Chart #6	2872910	Edge Chassis		
440 Pro XR	2004	Polaris Chart #6	2872910	Edge Chassis		
440 SKS	92-93	Polaris Chart #2		Wedge or Original		
440 SKS	94-95	Polaris Chart #3		Evolved Chassis		
440 XC	1997	Polaris Chart #2		Wedge or Original		
440 XC SP	2000	Polaris Chart #6	2872910	Edge Chassis		
440 XCF / XCR	1999	Polaris Chart #5		Gen II Chassis		
440 XCR	92-98	Polaris Chart #2		Wedge or Original		
440 XCR	1999	Polaris Chart #5		Gen II Chassis		
440 XCR SP	94-95	Polaris Chart #2		Wedge or Original		
440 XCR SP	1999	Polaris Chart #6	2872910	Edge Chassis		
500	89-92	Polaris Chart #2		Wedge or Original		
500 Carb / RMK / SKS	95-96	Polaris Chart #3		Evolved Chassis		
500 Classic	89-93	Polaris Chart #2		Wedge or Original		
500 Classic	1999	Polaris Chart #3		Evolved Chassis		
500 Classic	00-01	Polaris Chart #5		Gen II Chassis		
500 Classic	02-06	Polaris Chart #6	2872910	Edge Chassis		
500 Classic Touring	01-03	Polaris Chart #5		Gen II Chassis		
500 Edge	03-04	Polaris Chart #6	2872910	Edge Chassis		
500 EFI, EFI SKS	1993	Polaris Chart #2		Wedge or Original		
500 EFI, RMK, SKS	95-97	Polaris Chart #3		Evolved Chassis		
500 Indy	97-99	Polaris Chart #3		Evolved Chassis		
500 Indy	2000	Polaris Chart #5		Gen II Chassis		
500 RMK	97-99	Polaris Chart #3		Evolved Chassis		
500 RMK	00-02	Polaris Chart #5		Gen II Chassis		
500 SKS	89-92	Polaris Chart #2		Wedge or Original		
500 SKS	95/97	Polaris Chart #3		Evolved Chassis		
500 SP	89-92	Polaris Chart #2		Wedge or Original		
500 SP EFI, 500 SPX	1992	Polaris Chart #2		Wedge or Original		
500 XC	01-02	Polaris Chart #6	2872910	Edge Chassis		
500 XC / XC SP	99-00	Polaris Chart #3		Evolved Chassis		
500 XC Edge / XC Edge F/O / XC Edge M-10 F/O	2003	Polaris Chart #6	2872910	Edge Chassis		
500 XC SP / XC SP Edge	01-07	Polaris Chart #6	2872910	Edge Chassis		
500 XC SP Edge M-10	04-05	Polaris Chart #6	2872910	Edge Chassis		
550 Adventure	2017	Polaris Chart #8		Pro Ride Chassis		
550 Classic	05-06	Polaris Chart #6	2872910	Edge Chassis		
550 Classic Edge	03-04	Polaris Chart #6	2872910	Edge Chassis		
550 Edge LX	2007	Polaris Chart #6	2872910	Edge Chassis		
550 F/C Classic	2002	Polaris Chart #6	2872910	Edge Chassis		
550 Indy / ES	14-22	Polaris Chart #8		Pro Ride Chassis		
550 Indy Adventure	14-23	Polaris Chart #8		Pro Ride Chassis		
550 Indy EVO	19-23	Polaris Chart #8		Pro Ride Chassis		
550 Indy EVO ES	2019	Polaris Chart #8		Pro Ride Chassis		
550 Indy LXT / LXT ES / LE (all)	14-15/17-23	Polaris Chart #8		Pro Ride Chassis		
550 Indy Voyageur / ES	14-17	Polaris Chart #8		Pro Ride Chassis		
550 IQ LXT	11-13	Polaris Chart #7		IQ Chassis		
550 IQ Shift, ES	09-13	Polaris Chart #7		IQ Chassis		

**WINDSHIELD APPLICATIONS - POLARIS**

Model	Year	TCI PART #	OEM #	Notes	H x W	Color
550 LX	2008	Polaris Chart #6	2872910	Edge Chassis		
550 LXT (all)	2016	Polaris Chart #8		Pro Ride Chassis		
550 Pro X Fan	2004	Polaris Chart #6	2872910	Edge Chassis		
550 RMK EVO	2020	Polaris Chart #8		Pro Ride Chassis		
550 Shift, ES	11-13	Polaris Chart #7		IQ Chassis		
550 Voyageur	17/19/21-23	Polaris Chart #8		Pro Ride Chassis		
550 Widetrack LX (all)	15-19	Polaris Chart #5		Gen II Chassis		
600 Axys Indy XC	19-21	Polaris Chart #9		Axys Chassis		
600 Axys Pro RMK (all)	16-18	Polaris Chart #9		Axys Chassis		
600 Classic	02-06	Polaris Chart #6	2872910	Edge Chassis		
600 Classic Edge	2001	Polaris Chart #6	2872910	Edge Chassis		
600 Classic Touring	01-03	Polaris Chart #5		Gen II Chassis		
600 Classic Touring	2004	Polaris Chart #6	2872910	Edge Chassis		
600 Cleanfire Switchback	2007	Polaris Chart #7		IQ Chassis		
600 Dragon ES, SP	2009	Polaris Chart #7		IQ Chassis		
600 Dragon Switchback	08/10	Polaris Chart #7		IQ Chassis		
600 Edge Touring	05-06	Polaris Chart #6	2872910	Edge Chassis		
600 Fusion HO	2006	761-2360	2875511	IQ Fusion Chassis	15 1/2 M	Smoke
600 HO IQ	2007	Polaris Chart #7		IQ Chassis		
600 HO IQ Cleanfire	2007	Polaris Chart #7		IQ Chassis		
600 HO IQ Touring Cleanfire	2007	Polaris Chart #7		IQ Chassis		
600 HO IQ LX Cleanfire	2007	Polaris Chart #7		IQ Chassis		
600 HO RMK	2006	Polaris Chart #7		IQ Chassis		
600 HO Switchback	06-07	Polaris Chart #7		IQ Chassis		
600 Indy	13-20	Polaris Chart #8		Pro Ride Chassis		
600 Indy Adventure	20-21	Polaris Chart #9		Axys Chassis		
600 Indy LTD	2016	Polaris Chart #8		Pro Ride Chassis		
600 Indy SP	13-18	Polaris Chart #8		Pro Ride Chassis		
600 Indy SP	19-22	Polaris Chart #9		Axys Chassis		
600 Indy Voyageur	2015	Polaris Chart #8		Pro Ride Chassis		
600 Indy XCR	20-21	Polaris Chart #9		Axys Chassis		
600 Indy XCR, SE, SP	96-99	Polaris Chart #4		Aggressive Chassis		
600 IQ Dragon	2008	Polaris Chart #7		IQ Chassis		
600 IQ LX	2008	Polaris Chart #7		IQ Chassis		
600 IQ LXT	11-13	Polaris Chart #7		IQ Chassis		
600 IQ LXT	14-15	Polaris Chart #8		Pro Ride Chassis		
600 IQ Shift, ES	09-12	Polaris Chart #7		IQ Chassis		
600 IQ Touring	09-10	Polaris Chart #7		IQ Chassis		
600 IQ Widetrak	2017	Polaris Chart #7		IQ Chassis		
600 IQ, ES	2009	Polaris Chart #7		IQ Chassis		
600 LE	1986	Polaris Chart #1		Old Style Hood		
600 Pro Ride Rush	2010	Polaris Chart #8		Pro Ride Chassis		
600 Pro RMK	19-21	Polaris Chart #9		Axys Chassis		
600 Pro RMK, LE	12-15	Polaris Chart #8		Pro Ride Chassis		
600 Pro Rush S	2017	Polaris Chart #9		Axys Chassis		
600 Pro X	01-04	Polaris Chart #6	2872910	Edge Chassis		
600 Pro X2	2004	Polaris Chart #6	2872910	Edge Chassis		
600 Racer	08-16	619-2038			12"	Black
600 Racer	17-18	Polaris Chart #9		Axys Chassis		
600 RMK	1998	Polaris Chart #2		Wedge or Original		
600 RMK	99-01	Polaris Chart #5		Gen II Chassis		
600 RMK	07-08/10	Polaris Chart #7		IQ Chassis		
600 RMK	11-16	Polaris Chart #8		Pro Ride Chassis		
600 RMK	17-21	Polaris Chart #9		Axys Chassis		
600 RMK Shift	08-09	Polaris Chart #7		IQ Chassis		
600 RR	08-09	619-2038			12"	Black
600 Rush (all)	11-13	Polaris Chart #8		Pro Ride Chassis		
600 Rush Pro S	15-17/19-20	Polaris Chart #9		Axys Chassis		
600 Rush Pro-R (all)	11-14	Polaris Chart #8		Pro Ride Chassis		
600 Rush Pro-X	15-17	Polaris Chart #9		Axys Chassis		
600 Rush XCR	17/19-20	Polaris Chart #9		Axys Chassis		
600 SE	1985	Polaris Chart #1		Old Style Hood		
600 Shift, ES	2011	Polaris Chart #7		IQ Chassis		
600 Switchback Adventure	12-14	Polaris Chart #8		Pro Ride Chassis		
600 Switchback Adventure	15-20	Polaris Chart #9		Axys Chassis		
600 Switchback Assault	14-16	Polaris Chart #8		Pro Ride Chassis		
600 Switchback Assault	17-20	Polaris Chart #9		Axys Chassis		
600 Switchback Assault	2021	Polaris Chart #10		Matryx Chassis		



## WINDSHIELD APPLICATIONS - POLARIS

Model	Year	TCI PART #	OEM #	Notes	H x W	Color
600 Switchback Dragon	2009	Polaris Chart #7		IQ Chassis		
600 Switchback, ES	08-10	Polaris Chart #7		IQ Chassis		
600 Switchback, ES	11-14	Polaris Chart #8		Pro Ride Chassis		
600 Switchback, F/O	04-05	Polaris Chart #6	2872910	Edge Chassis		
600 Switchback Pro R (all)	12-14	Polaris Chart #8		Pro Ride Chassis		
600 Switchback Pro S	15-21	Polaris Chart #9		Axys Chassis		
600 Switchback Pro X / ES	15-17	Polaris Chart #9		Axys Chassis		
600 Switchback SP	18-20	Polaris Chart #9		Axys Chassis		
600 Switchback XCR	18-21	Polaris Chart #9		Axys Chassis		
600 Touring, 600 Triumph	2000	Polaris Chart #5		Gen II Chassis		
600 Voyager	14/19	Polaris Chart #8		Pro Ride Chassis		
600 Voyager	17-19/21	Polaris Chart #9		Axys Chassis		
600 Widetrack IQ	10-16	Polaris Chart #7		IQ Chassis		
600 XC	97-98	Polaris Chart #2		Wedge or Original		
600 XC	1999	Polaris Chart #5		Gen II Chassis		
600 XC SP	99-00	Polaris Chart #5		Gen II Chassis		
600 XC Deluxe	2000	Polaris Chart #5		Gen II Chassis		
600 XC Edge F/O	2003	Polaris Chart #6	2872910	Edge Chassis		
600 XC SP	2001	Polaris Chart #6	2872910	Edge Chassis		
600 XC SP Edge	02-03	Polaris Chart #6	2872910	Edge Chassis		
600 XCR	89-96	Polaris Chart #2		Wedge or Original		
600 XCR	97-98	Polaris Chart #4		Aggressive Chassis		
600, Indy	83-87	Polaris Chart #1		Old Style Hood		
650, 650 SKS, 650 RXL, 650 RXL SKS	88/90-92	Polaris Chart #2		Wedge or Original		
650 Indy Adventure	22-23	Polaris Chart #10		Matryx Chassis		
650 Indy SP	2023	Polaris Chart #10		Matryx Chassis		
650 Indy XC, XCR	22-23	Polaris Chart #10		Matryx Chassis		
650 Matryx Indy XC	2021	Polaris Chart #10		Matryx Chassis		
650 Pro RMK Matryx / Slash	22-23	Polaris Chart #10		Matryx Chassis		
650 RMK Khaos Matryx / Slash	22-23	Polaris Chart #10		Matryx Chassis		
650 SKS	2023	Polaris Chart #10		Matryx Chassis		
650 Switchback Assault	22-23	Polaris Chart #10		Matryx Chassis		
650 Switchback SP	2023	Polaris Chart #10		Matryx Chassis		
650 Switchback XC	22-23	Polaris Chart #10		Matryx Chassis		
650 Voyageur	22-23	Polaris Chart #10		Matryx Chassis		
700 Classic	2001	Polaris Chart #5		Gen II Chassis		
700 Classic	02-03	Polaris Chart #6	2872910	Edge Chassis		
700 Classic	2006	Polaris Chart #7		IQ Chassis		
700 Classic Touring	03-04	Polaris Chart #6	2872910	Edge Chassis		
700 Cleanfire Dragon	2007	Polaris Chart #7		IQ Chassis		
700 Dragon Switchback	2008	Polaris Chart #7		IQ Chassis		
700 Edge RMK	2003	Polaris Chart #6	2872910	Edge Chassis		
700 Edge XC SP Edge F/O	2002	Polaris Chart #6	2872910	Edge Chassis		
700 Edge XC/SP	2003	Polaris Chart #6	2872910	Edge Chassis		
700 Fusion	06	761-2360	2875511	IQ Fusion Chassis	15 1/2 M	Smoke
700 HO Touring	2006	Polaris Chart #7		IQ Chassis		
700 IQ, IQ Dragon	2008	Polaris Chart #7		IQ Chassis		
700 Pro X	03-04	Polaris Chart #6	2872910	Edge Chassis		
700 Pro X2	2004	Polaris Chart #6	2872910	Edge Chassis		
700 RMK	97-98	Polaris Chart #2		Wedge or Original		
700 RMK	00-01	Polaris Chart #5		Gen II Chassis		
700 RMK	2002	Polaris Chart #6	2872910	Edge Chassis		
700 RMK	04-05	Polaris Chart #6	2872910	Edge Chassis		
700 RMK	2006	Polaris Chart #7		IQ Chassis		
700 SKS	1997	Polaris Chart #2		Wedge or Original		
700 SKS	2003	Polaris Chart #6	2872910	Edge Chassis		
700 Switchback	2003	Polaris Chart #6	2872910	Edge Chassis		
700 Switchback	2008	Polaris Chart #7		IQ Chassis		
700 XC	97-98	Polaris Chart #2		Wedge or Original		
700 XC Deluxe	2000	Polaris Chart #5		Gen II Chassis		
700 XC Edge F/O	2004	Polaris Chart #6	2872910	Edge Chassis		
700 XC SP	99-00	Polaris Chart #5		Gen II Chassis		
700 XC SP	2001	Polaris Chart #6	2872910	Edge Chassis		
700 XC SP M-10 F/O	2005	Polaris Chart #6	2872910	Edge Chassis		
700 XCR	98-99	Polaris Chart #4		Aggressive Chassis		
800 Assault RMK	09-10	Polaris Chart #7		IQ Chassis		
800 Axys Pro RMK (all)	16-18	Polaris Chart #9		Axys Chassis		
800 Axys Pro RMK Assault	17-18	Polaris Chart #9		Axys Chassis		



**WINDSHIELD APPLICATIONS - POLARIS**

Model	Year	TCI PART #	OEM #	Notes	H x W	Color
800 Axys Pro S / 800 Axys Pro X SC	2017	Polaris Chart #9		Axys Chassis		
800 Axys SKS (all)	16-18	Polaris Chart #9		Axys Chassis		
800 Axys XCR	2017	Polaris Chart #9		Axys Chassis		
800 Classic Touring	03-04	Polaris Chart #6	2872910	Edge Chassis		
800 Dragon ES	2009	Polaris Chart #7		IQ Chassis		
800 Dragon RMK	2010	Polaris Chart #7		IQ Chassis		
800 Dragon SP / ES	2009	Polaris Chart #7		IQ Chassis		
800 Dragon Switchback / ES	2010	Polaris Chart #7		IQ Chassis		
800 Edge Touring	2005	Polaris Chart #6	2872910	Edge Chassis		
800 Indy / SP / ES / FO	14-16	Polaris Chart #8		Pro Ride Chassis		
800 Indy Adventure	2020	Polaris Chart #9		Axys Chassis		
800 Indy XC	19-20	Polaris Chart #9		Axys Chassis		
800 Indy XCR	00-03	Polaris Chart #5		Gen II Chassis		
800 Indy XCR	20-21	Polaris Chart #9		Axys Chassis		
800 IQ, 800 IQ ES	08-10	Polaris Chart #7		IQ Chassis		
800 LE	2001	Polaris Chart #6	2872910	Edge Chassis		
800 Pro RMK (all)	11-15	Polaris Chart #8		Pro Ride Chassis		
800 Pro RMK (all)	19-20	Polaris Chart #9		Axys Chassis		
800 Pro Rush Pro-S / 800 Pro Rush Pro-X SC Select	2018	Polaris Chart #9		Axys Chassis		
800 Pro X	03-04	Polaris Chart #6	2872910	Edge Chassis		
800 Pro X2	2004	Polaris Chart #6	2872910	Edge Chassis		
800 Pro XR	2004	Polaris Chart #6	2872910	Edge Chassis		
800 RMK	00-01	Polaris Chart #5		Gen II Chassis		
800 RMK	2003	Polaris Chart #6	2872910	Edge Chassis		
800 RMK / ES	09-10	Polaris Chart #7		IQ Chassis		
800 RMK / ES	11-15	Polaris Chart #8		Pro Ride Chassis		
800 RMK Assault	11-15	Polaris Chart #8		Pro Ride Chassis		
800 RMK Assault	16/19	Polaris Chart #9		Axys Chassis		
800 RMK F/O	02/04-05	Polaris Chart #6	2872910	Edge Chassis		
800 RMK Khaos	2020	Polaris Chart #9		Axys Chassis		
800 RMK R/ Pro	12-15	Polaris Chart #8		Pro Ride Chassis		
800 RMK Shift	2009	Polaris Chart #7		IQ Chassis		
800 RMK Vertical Escape	2003	Polaris Chart #6	2872910	Edge Chassis		
800 Rush (all)	11-13	Polaris Chart #8		Pro Ride Chassis		
800 Rush Pro S (all)	15-16/19-20	Polaris Chart #9		Axys Chassis		
800 Rush Pro-R (all)	11-14	Polaris Chart #8		Pro Ride Chassis		
800 Rush Pro-X (all)	15-16	Polaris Chart #9		Axys Chassis		
800 Rush XCR	2018	Polaris Chart #9		Axys Chassis		
800 SKS	2003	Polaris Chart #6	2872910	Edge Chassis		
800 SKS (all)	19-20	Polaris Chart #9		Axys Chassis		
800 Switchback	04-05	Polaris Chart #6	2872910	Edge Chassis		
800 Switchback / ES	09-10	Polaris Chart #7		IQ Chassis		
800 Switchback / ES	12-14	Polaris Chart #8		Pro Ride Chassis		
800 Switchback Adventure	2014	Polaris Chart #8		Pro Ride Chassis		
800 Switchback Adventure	16-20	Polaris Chart #9		Axys Chassis		
800 Switchback Assault	11-16	Polaris Chart #8		Pro Ride Chassis		
800 Switchback Assault	17-20	Polaris Chart #9		Axys Chassis		
800 Switchback Dragon	2009	Polaris Chart #7		IQ Chassis		
800 Switchback Pro S	15-20	Polaris Chart #9		Axys Chassis		
800 Switchback Pro-R (all)	12-14	Polaris Chart #8		Pro Ride Chassis		
800 Switchback Pro-X / XC	15-18	Polaris Chart #9		Axys Chassis		
800 Switchback XCR	18-20	Polaris Chart #9		Axys Chassis		
800 Titan Adventure	19-21	Polaris Chart #9		Axys Chassis		
800 Titan SP	18-21	Polaris Chart #9		Axys Chassis		
800 Titan XC	19-21	Polaris Chart #9		Axys Chassis		
800 XC Edge, F/O	03-04	Polaris Chart #6	2872910	Edge Chassis		
800 XC SP	01-03	Polaris Chart #6	2872910	Edge Chassis		
800 XC SP M-10 F/O	01-03	Polaris Chart #6	2872910	Edge Chassis		
800 XCR	1999	Polaris Chart #4		Aggressive Chassis		
800 XCR	00-02	Polaris Chart #5		Gen II Chassis		
850 Axys Indy XC	19-21	Polaris Chart #9		Axys Chassis		
850 Indy Adventure	20-21	Polaris Chart #9		Axys Chassis		
850 Indy Adventure	22-23	Polaris Chart #10		Matryx Chassis		
850 Indy VR1	21-23	Polaris Chart #10		Matryx Chassis		
850 Indy XC, XCR	22-23	Polaris Chart #10		Matryx Chassis		
850 Indy XCR	2020	Polaris Chart #9		Axys Chassis		
850 Matryx Indy XC	2021	Polaris Chart #10		Matryx Chassis		
850 Pro RMK	19-22	Polaris Chart #9		Axys Chassis		

## WINDSHIELD APPLICATIONS - POLARIS

Model	Year	TCI PART #	OEM #	Notes	H x W	Color
850 Pro RMK Matryx / Slash	22-23	Polaris Chart #10		Matryx Chassis		
850 RMK Khaos	20-21	Polaris Chart #9		Axys Chassis		
850 RMK Khaos Matryx / Slash	22-23	Polaris Chart #10		Matryx Chassis		
850 Rush Pro S / 850 Rush XCR	19-20	Polaris Chart #9		Axys Chassis		
850 SKS (all)	19-21	Polaris Chart #9		Axys Chassis		
850 Switchback Assault	19-20	Polaris Chart #9		Axys Chassis		
850 Switchback Assault	2021	Polaris Chart #10		Matryx Chassis		
850 Switchback Pro-S	19-21	Polaris Chart #9		Axys Chassis		
850 Switchback XC	22-23	Polaris Chart #10		Matryx Chassis		
850 Switchback XCR	19-21	Polaris Chart #9		Axys Chassis		
900 Fusion	05-06	761-2360	2875511	IQ Fusion Chassis	15 1/2 M	Smoke
900 RMK	05-06	Polaris Chart #7		IQ Chassis		
900 Switchback	05-06	Polaris Chart #7		IQ Chassis		
Apollo	79-80	761-2230	5430567		16 M	Clear
Centurion 500	79-80	761-2130			13	Clear
Centurion, Indy 500	81-82	Polaris Chart #1		Old Style Hood		
Charger	69-71	761-2020	5850011		14	Clear
Classic	95-98	Polaris Chart #3		Evolved Chassis		
Classic Touring	96-99	Polaris Chart #3		Evolved Chassis		
Classic Touring	2000	Polaris Chart #5		Gen II Chassis		
Cobra	1979	761-2100	5430482		15	Clear
Colt	72-73	761-2030	2631102			
Colt SS 340	1978	761-2070	5430494			
Colt,SS	74-78	761-2061	5430411		8" Low	Smoke
Custom	74-77	761-2061	5430411		8" Low	Smoke
Cutlass	81-86	761-2271	5430642			
Dragon RMK	2007	Polaris Chart #7		IQ Chassis		
Electra	74-78	761-2061	5430411		8" Low	Smoke
Frontier Classic	03-04	Polaris Chart #6	2872910	Edge Chassis		
Frontier Touring	03-05	Polaris Chart #6	2872910	Edge Chassis		
FS Classic	2006	Polaris Chart #7		IQ Chassis		
FS IQ Touring	07-09	Polaris Chart #7		IQ Chassis		
FS Touring	2006	Polaris Chart #7		IQ Chassis		
FS Widetrack IQ	10-12	Polaris Chart #7		IQ Chassis		
FS Widetrack IQ	2013	Polaris Chart #8		Pro Ride Chassis		
FST Classic	2006	Polaris Chart #7		IQ Chassis		
FST IQ Cruiser	2007	Polaris Chart #7		IQ Chassis		
FST IQ LX	2007	Polaris Chart #7		IQ Chassis		
FST IQ Switchback	2007	Polaris Chart #7		IQ Chassis		
FST IQ Touring	07-10	Polaris Chart #7		IQ Chassis		
FST Switchback	2006	Polaris Chart #7		IQ Chassis		
FST Touring	2006	Polaris Chart #7		IQ Chassis		
Fusion 600/700/800	05-06	761-2360	2875511	IQ Fusion Chassis	15 1/2 M	Smoke
Galaxy	80-81	761-2230	5430567		16 M	Clear
Gemini	79-83	761-2230	5430567		16 M	Clear
Indy Frontier	2002	Polaris Chart #6	2872910	Edge Chassis		
IQ Cruiser	2008	Polaris Chart #7		IQ Chassis		
IQ Shift	2008	Polaris Chart #7		IQ Chassis		
IQ Turbo Dragon	08/10	Polaris Chart #7		IQ Chassis		
IQ Turbo LX	2008	Polaris Chart #7		IQ Chassis		
IQ Turbo LXT	13-14	Polaris Chart #7		IQ Chassis		
IQ Widetrack	2009	Polaris Chart #7		IQ Chassis		
Lite-DLX-GT-Touring, Starlite GT	91-98	761-2260 761-2261	5431207 5431207		19 19	Clear Smoke
Long Track-Reverse	84-90	761-2151	5430692	w/headlight cut out	16 1/2	Smoke
RMK	05-06	761-2360	2875511	IQ Fusion Chassis	15 1/2 M	Smoke
RMK	2022	Polaris Chart #9		Axys Chassis		
RMK EVO	22-23	Polaris Chart #8		Pro Ride Chassis		
RMK Khaos Axys	2022	Polaris Chart #9		Axys Chassis		
Sport	83-86	761-2271	5430642		16 1/4	Smoke
Sport	87-89	Polaris Chart #1		Old Style Hood		
Sport	1999	Polaris Chart #5		Gen II Chassis		
Sport Touring	99-03	Polaris Chart #5		Gen II Chassis		
Sport Touring	2004	Polaris Chart #6	2872910	Edge Chassis		
Sprint / ES	86-90	761-2271	5430642		16 1/4	Smoke
SS (Super Sport)	83-86	761-2271	2870532/050642		16 1/4	Smoke
Star	83-90	761-2271	5430642		16 1/4	Smoke
Star L/T	84-90	761-2151	5430692	w/headlight cut out	16 1/2	Smoke

**WINDSHIELD APPLICATIONS - POLARIS**

Model	Year	TCI PART #	OEM #	Notes	H x W	Color
Star Track	84-90	761-2151	5430692	w/headlight cut out	16 1/2	Smoke
Star	1994	761-2260	5431207		19	Clear
		761-2261	5431207		19	Smoke
Starfire	1976	761-2081	5430489/2870439		14 1/2 M	Clear
Storm, SKS	93-95	Polaris Chart #2		Wedge or Original		
Storm (all)	96-98	Polaris Chart #4		Aggressive Chassis		
Supersport	94-97	Polaris Chart #2		Wedge or Original		
Supersport	99-00	Polaris Chart #5		Gen II Chassis		
Supersport, Supersport Edge	04-08	Polaris Chart #6	2872910	Edge Chassis		
Supersport M-10	04-08	Polaris Chart #6	2872910	Edge Chassis		
Switchback Sport	2023	Polaris Chart #8		Pro Ride Chassis		
TC	75	<b>761-2120</b>	5430359		11	Smoke
Titan Adventure	22-23	Polaris Chart #9		Axys Chassis		
Titan XC	2022	Polaris Chart #9		Axys Chassis		
Trail	83-89	Polaris Chart #1		Old Style Hood		
Trail	90-94	Polaris Chart #2		Wedge or Original		
Trail	95-99	Polaris Chart #3		Evolved Chassis		
Trail Deluxe	1988	Polaris Chart #1		Old Style Hood		
Trail Deluxe	90-94	Polaris Chart #2		Wedge or Original		
Trail Deluxe	1995	Polaris Chart #3		Evolved Chassis		
Trail ES	87-89	Polaris Chart #1		Old Style Hood		
Trail RMK	99-03	Polaris Chart #5		Gen II Chassis		
Trail RMK, 136, ES, Fleet	04-10	Polaris Chart #6	2872910	Edge Chassis		
Trail SKS	87-89	Polaris Chart #1		Old Style Hood		
Trail SP	86/88-89	Polaris Chart #1		Old Style Hood		
Trail Supertrak	83-86	Polaris Chart #1		Old Style Hood		
Trail Touring	96-99	Polaris Chart #3		Evolved Chassis		
Trail Touring	00/03	Polaris Chart #5		Gen II Chassis		
Trail Touring, Deluxe	04-10	Polaris Chart #6	2872910	Edge Chassis		
Tran Sport	96-98	Polaris Chart #2		Wedge or Original		
Tran Sport	1999	Polaris Chart #5		Gen II Chassis		
Turbo IQ	11-12	Polaris Chart #7		IQ Chassis		
Turbo IQ Dragon	2009	Polaris Chart #7		IQ Chassis		
Turbo IQ LX	11-12	Polaris Chart #7		IQ Chassis		
Turbo IQ LXT	2012	Polaris Chart #7		IQ Chassis		
Turbo LX	2010	Polaris Chart #7		IQ Chassis		
Turbo Switchback	08-09	Polaris Chart #7		IQ Chassis		
TX	73	<b>761-2051</b>	5430263		13	Clear
TX	74-75	<b>761-2061</b>	5430411		8" Low	Smoke
TX	76-79	<b>761-2081</b>	5430489		14.5	Clear
TX	1980	761-2242	5432242		17	Clear
TX Charger	70-71	<b>761-2050</b>	5850019		17	Smoke
TX-C 340	79	<b>761-2090</b>	5430538		17	Clear
TX-C	80-82	<b>761-2240</b>	5430578		15	Clear
TX-L	76-78	<b>761-2081</b>	5430489		14.5	Clear
TX-L	79-82	<b>761-2130</b>	5430543		13	Clear
TX-L Indy	80-84	Polaris Chart #1		Old Style Hood		
Ultra, RMK, SKS, SP (NOT SPX)	96-97	Polaris Chart #2		Wedge or Original		
Ultra SPX, SE	1997	Polaris Chart #4		Aggressive Chassis		
Ultra Touring	97-98	Polaris Chart #4		Aggressive Chassis		
Wide Track	91-94	Polaris Chart #2		Wedge or Original		
Wide Trak GT	93-97	Polaris Chart #2		Wedge or Original		
Wide Trak LX	94-98	Polaris Chart #2		Wedge or Original		
Widetrak LX	00-05/07-19	Polaris Chart #3		Gen II Chassis		
XCF, XCF SP	1999	Polaris Chart #5		Gen II Chassis		
XCR SP Edge	2001	Polaris Chart #6	2872910	Edge Chassis		
XLT Classic	98-99	Polaris Chart #3		Evolved Chassis		
XLT SP	98-99	Polaris Chart #4		Aggressive Chassis		
XLT	93-97	Polaris Chart #2		Wedge or Original		
XLT LTD	97-98	Polaris Chart #3		Evolved Chassis		
XLT LTD SP	1997	Polaris Chart #3		Evolved Chassis		
XLT RMK	95-97	Polaris Chart #2		Wedge or Original		
XLT SKS	93-97	Polaris Chart #2		Wedge or Original		
XLT SP	93-94/96-97	Polaris Chart #2		Wedge or Original		
XLT Touring	95-99	Polaris Chart #3		Evolved Chassis		

## YAMAHA WINDSHIELDS

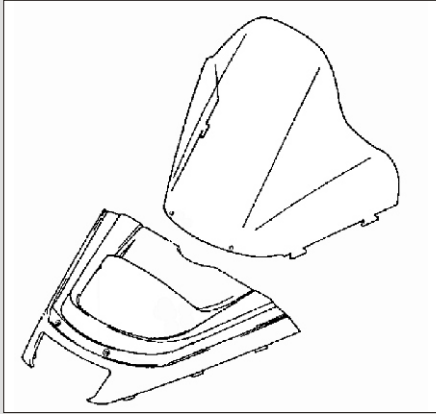

### SX Chassis with Single Headlight

#### YAMAHA Chart 1

DESCRIPTION	OEM	TCI #
Low 10" Black	8CV-77210-10	761-4409
Mid 13" Smoke	8CV-77210-00	761-4401
Cobra Low Tint w/black graphics 12.5"		619-4001



619-4001

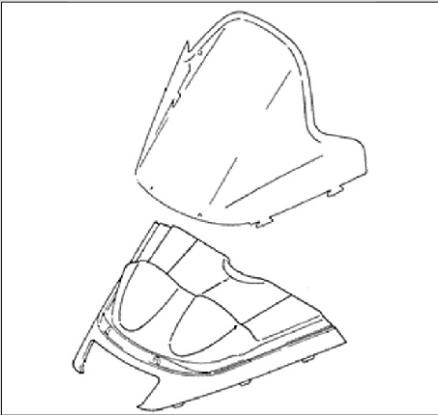

### SRX Dual Beam Headlight Chassis

#### YAMAHA Chart 2

DESCRIPTION	TCI #
Cobra Low Clear w/Black accent & flames 13"	619-4013
Cobra Low Tint 13"5	619-4015



619-4013



619-4015

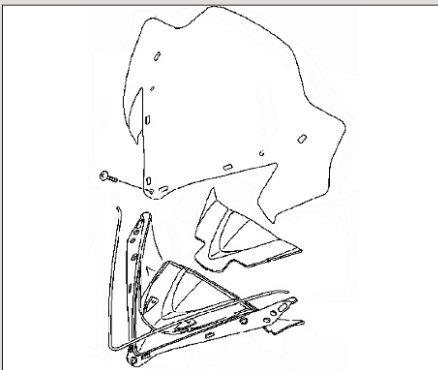

### RX -1 Chassis

#### YAMAHA Chart 3

DESCRIPTION	OEM	TCI #
Mid 14.5 x 28" Clear	SMA8FA9621	761-4500
Mid 14" Smoke	SMA8FA9621	761-4502
Clear 16"	8FA/J-K7210-10	761-4503
High Clear	SMA8FA96	761-4501
Cobra Low 10" Blue Chrome w/Cobra logo		619-4034
Cobra Mid 12" Blue Tint w/Cobra logo		619-4032



619-4034



## YAMAHA WINDSHIELDS

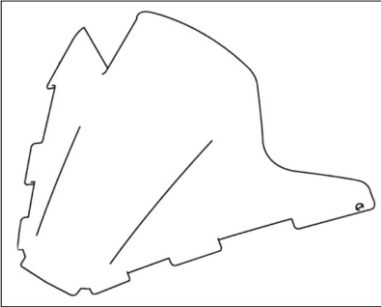

### SX Viper Chassis (does not fit 2014-15 models)

#### Yamaha Chart 4

DESCRIPTION	TCI #
Low 9.5" Clear	761-4330
Low 9.5" Smoke	761-4331
Cobra Low 10" Blue w/Cobra logo	619-4020
Cobra Mid 12.5" Clr w/red & blue flames	619-4021



619-4020

### SR Viper Chassis

#### Yamaha Chart 5

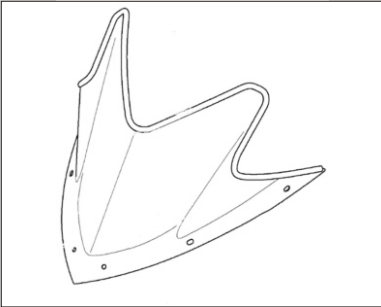

DESCRIPTION	TCI #
Cobra Low Tint 10.5"	619-4025
Cobra Mid Clear w/Black Fade 17"	619-4026
Cobra Mid Clear w/Black Fade 18"	619-4027



619-4025



619-4027

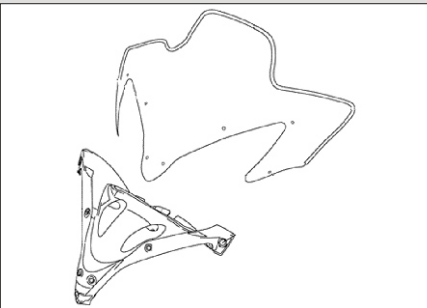

### Apex/Attak Chassis

#### Yamaha Chart 6

DESCRIPTION	TCI #
Cobra Tall Clear w/black fade 18.5"	619-4050



619-4050

## WINDSHIELD APPLICATIONS - YAMAHA

Model	Years	TCI PART #	OEM #	Notes	H x W	Color
Apex (all models)	06-18	Yamaha Chart #6		Apex/Attak Chassis		
Attak	06-10	Yamaha Chart #6		Apex/Attak Chassis		
Bravo (US models only-mounts with tabs)	82-83	761-4300	8R4-77210-00		13	Clear
Bravo (CDN models-mounts with screws)	82-83	761-4330			13	Clear
Bravo (US models only-mounts with tabs)	84-94	761-4310	8V7-77210-00		18 M	Clear
Bravo T, TS, LT	85-00	761-4330	86D-77210-00		21 H	Clear
Bravo Trapper	85-05	761-4330	80J-77210-00		21 H	Clear
Enticer	77-83	761-4053	8N4-77210-00 / 8F3-77210-00		12 L	Clear
		761-4050	8N5-77210-00		15	Clear
		761-4052	8R3-77210-00 / 71002-01-00		18 1/4 H	Clear
Enticer, ET 300, 340, 440	84-91	761-4030	8X1-77210-00 / 8W6-77210-00		17 M	Smoke
		761-4032	8X1-77210-00 / 8W8-77210-00		17 M	Clear
		761-4031	8X1-77210-00		22 H	Clear
ET340 & 410 II	92-98	761-4010	89X-77210-00		18	Clear
Excel III	81-83	761-4053	8N4-77210-00 / 8F3-77210-00		12 L	Clear
		761-4050	8N5-77210-00		15	Clear
		761-4052	8R3-77210-00 / 71002-01-00		18 1/4 H	Clear
Excel III	84-88	761-4030	8X1-77210-00 / 8W6-77210-00		17 M	Smoke
		761-4032	8X1-77210-00 / 8W8-77210-00		17 M	Clear
		761-4031	8X1-77210-00		22 H	Clear
Excel V	85-89	761-4080	80R-77210-00		21	Clear
Exciter	76-81	761-4090	8A5-77210-00		13 L	Clear
Exciter	87-90	761-4170	87F-77210-00 / 8V0-77210-00		9 1/2	Clear
		761-4179	8BH-77210-00 / 87F-77210-00		9 1/2	Black
Exciter II,ST, LE, SX	91-93	761-4181	88R-77210-00			
Mountain Max 600, 700 (97-00)	97-01	Yamaha Chart #1		SX Chassis with Single Headlight		
Mountain Max 600	2002					
Mountain Max 700	02-04	Yamaha Chart #2		SRX Dual Beam Headlight Chassis		
Mountain Max	21-23	Yamaha Chart #5		SR Viper Chassis		
Nytro, Nytro ER	06-07					
Ovation (CS340 E/LE)	98-00	761-4200	88E-77210-00 / 85M-77210-00		26"	Clear
		761-4201	88E-77210-00 / 85M-77210-00		26"	Smoke
Phazer	84-89	761-4170	87F-77210-00 / 8V0-77210-00		9 1/2	Clear
		761-4179	8BH-77210-00 / 87F-77210-00		9 1/2	Black
Phazer II	90-98	761-4170	87F-77210-00 / 8V0-77210-00		9 1/2	Clear
		761-4179	8BH-77210-00 / 87F-77210-00		9 1/2	Black
Phazer Mountain 480	1999	761-4170	87F-77210-00 / 8V0-77210-00		9 1/2	Clear
		761-4179	8BH-77210-00 / 87F-77210-00		9 1/2	Black
Phazer 500	99-01	Yamaha Chart #1		SX Chassis with Single Headlight		
Phazer Mountain Lite	00-01	Yamaha Chart #1		SX Chassis with Single Headlight		
Phazer 500 Deluxe	2001	Yamaha Chart #1		SX Chassis with Single Headlight		
Phazer-GT-FX-Mtn Lite	07-10	761-4532	8GC-9610-00	mounts req.	15 L	Smoke
		761-4530	8GK-K7210-00	mounts req.	18 M	Clear
		761-4531	8GK-K7210-00	mounts req.	18 MH	Smoke
RS Rage	05-18	Yamaha Chart #3		RX-1 Chassis		
RS Vector, ER, Mountain	03-06	Yamaha Chart #3		RX-1 Chassis		
RS Vector	08-18	Yamaha Chart #6		Apex/Attak Chassis		
RS Venture, GT, ER, LFX	05-18	Yamaha Chart #3		RX-1 Chassis		
RX-1, ER, Mountain, Warrior	05-07	Yamaha Chart #3		RX-1 Chassis		
Sidewinder	17-23	Yamaha Chart #5		SR Viper Chassis		
SL 351	1968	761-4280	802-77210-00			Clear
SM 292	73-74	761-4270	853-77210-00			Clear
SR Viper	14-23	Yamaha Chart #5		SR Viper Chassis		
SRV 580, SS 440	80-91	761-4291	8LO-77210-00		12	Smoke
		761-4292	ACC-71000-01		16 1/2 H	Smoke
SRX	78-80	761-4100	8JO-77210-00		9	Smoke
SRX 440	1981	761-4100	8M6-77210-00		9	Smoke
SRX 600	98-00	Yamaha Chart #1		SX Chassis with Single Headlight		
SRX 700	98-99	Yamaha Chart #1		SX Chassis with Single Headlight		
SRX 700	00-02	Yamaha Chart #2		SRX Dual Beam Headlight Chassis		
SS 440	80-85	761-4291	83N/ 8LO-77210-00		12	Smoke
		761-4292	ACC-71000-01		16 1/2 H	Smoke
STX	76-77	761-4090	8A5-77210-00		13 L	Clear
SV 80 Sno Scoot	88-91	761-4361	ACC-11142-00	w/hardware		Smoke
SV 125 Sno Sport	90-92	761-4361	ACC-11142-00	w/hardware		Smoke
SX Venom, ER	2005	Yamaha Chart #4		Viper Chassis		
SX Viper, ER, S	02-04	Yamaha Chart #4		Viper Chassis		
SX Viper Mountain	02-06	Yamaha Chart #4		Viper Chassis		



**WINDSHIELD APPLICATIONS - YAMAHA**

Model	Years	TCI PART #	OEM #	Notes	H x W	Color
SXR 500, 600	00-01	Yamaha Chart #1		SX Chassis with Single Headlight		
SX 600R	02-03	Yamaha Chart #2		SRX Dual Beam Headlight Chassis		
SX 700R	2001	Yamaha Chart #2		SRX Dual Beam Headlight Chassis		
Transport	22-23	Yamaha Chart #5		SR Viper Chassis		
Venture 500, 600	98-01	Yamaha Chart #1		SX Chassis with Single Headlight		
Venture 500, XL	99-08	Yamaha Chart #1		SX Chassis with Single Headlight		
Venture 600	02-03	Yamaha Chart #2		SRX Dual Beam Headlight Chassis		
Venture 600	04-06	Yamaha Chart #4		Viper Chassis		
Venture 700, XL	98-00	Yamaha Chart #1		SX Chassis with Single Headlight		
Venture 700	01-03	Yamaha Chart #2		SRX Dual Beam Headlight Chassis		
Venture 700	2004	Yamaha Chart #4		Viper Chassis		
Venture Lite	07-09	761-4360	8GJ-K7210-00		H	Clear
Viking (VK), Viking II, Viking III	88-05	761-4340	86V-77210-00 / 83R-77210-00		14 1/2	Clear
V-Max (VMX)	83-91	761-4100	8M6-77210-00		9 L	Smoke
V-Max 4, 750, 800	92-97	761-4120	89A-77210-00		11 1/2 M	Clear
V-Max 500, 600	94-96	761-4120	89A-77210-00		11 1/2 M	Clear
V-Max 500, 600, 700	99-00	Yamaha Chart #1		SX Chassis with Single Headlight		
V-Max 600 ER	02-03	Yamaha Chart #2		SRX Dual Beam Headlight Chassis		
V-Max 700 Deluxe	01-02	Yamaha Chart #2		SRX Dual Beam Headlight Chassis		
V-Max 700 ER	2002	Yamaha Chart #2		SRX Dual Beam Headlight Chassis		
V-Max Deluxe 500, 600	99-01	Yamaha Chart #1		SX Chassis with Single Headlight		
V-Max Deluxe 700	99-00	Yamaha Chart #1		SX Chassis with Single Headlight		
V-Max SX 500, 600, 700	97-99	Yamaha Chart #1		SX Chassis with Single Headlight		
V-Max SX-R 500, 600	00-01	Yamaha Chart #1		SX Chassis with Single Headlight		
V-Max SX-R 700	2000	Yamaha Chart #1		SX Chassis with Single Headlight		
V-Max XT 500, 600	97-98	Yamaha Chart #1		SX Chassis with Single Headlight		
V-Max XT 700	1987	Yamaha Chart #1		SX Chassis with Single Headlight		
V-Max XTC 500, 600	97-98	Yamaha Chart #1		SX Chassis with Single Headlight		
V-Max XTC 700	1998	Yamaha Chart #1		SX Chassis with Single Headlight		
V-Max XTC Deluxe 500, 600, 700	1998	Yamaha Chart #1		SX Chassis with Single Headlight		